

INDUSTRIAL CENTER MOUNT UNIT COOLERS

Technical Guide



TABLE OF CONTENTS



3	Features & Benefits
4	Nomenclature
5	Magna Simulation Capacity- Air Defrost
5	Performance Data
5	Air Defrost 60 Hz
7	Air Defrost 50 Hz
9	Unit Specifications
12	Magna Simulation Capacity- Electric Defrost
12	Performance Data
12	Electric Defrost 60 Hz
14	Electric Defrost 50 Hz
16	Unit Specifications
28	Magna Simulation Capacity- Hot Gas Defrost
28	Performance Data
28	Hot Gas Defrost 60 Hz
30	Hot Gas Defrost 50 Hz
32	Unit Specifications
44	Physical Data
44	Physical Data
44	Air Defrost
45	Electric Defrost
46	Hot Gas Defrost
47	Dimensional Data

FEATURES & BENEFITS

STANDARD FEATURES

- Heavy duty aluminum cabinet
- High capacity aluminum fin/copper tube evaporator coils with enhanced tubes
- Capacity ranges from 36,000 to 180,000 btuh
- Air, Electric and Hot gas defrost models
- Coil Fin spacing from 3 to 6 FPI
- High efficiency totally enclosed fan motors
- Double wall insulated hinged drain pan.
- Hinged fan venturi panels
- Hinged end service panels

OPTIONALS

- External rotor motors with hinged venturi panel
- Wash down rated motors
- Variable speed motors
- Variable speed motor controls
- White painted cabinet
- Stainless steel cabinet
- IntelliGen™ Refrigeration Controller
- Mounted thermal expansion valves
- Mounted electronic expansion valves
- Mounted non-fused disconnect switch
- Coil coatings
- CO₂ coil designs
- Long air throw fan and motor designs
- Mounted solenoid valve
- Mounted thermostat

OUTSTANDING FEATURES

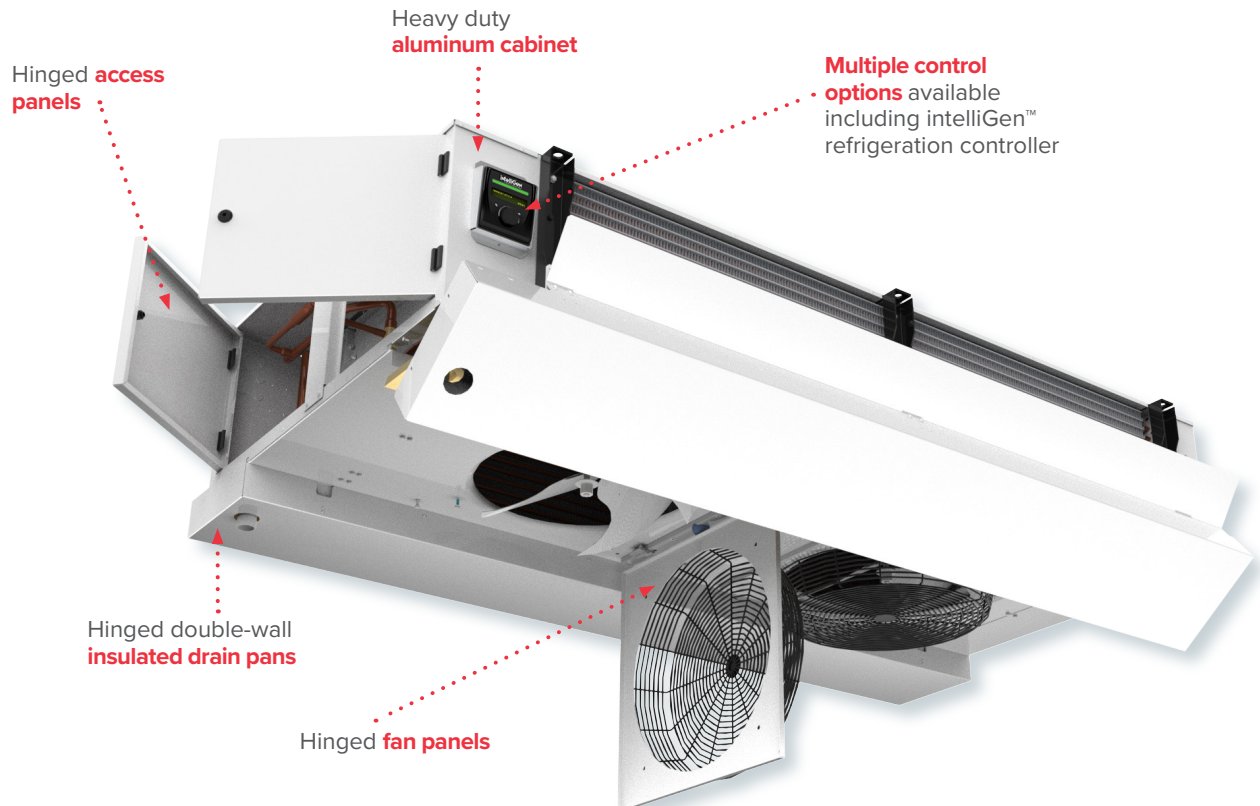

NOMENCLATURE

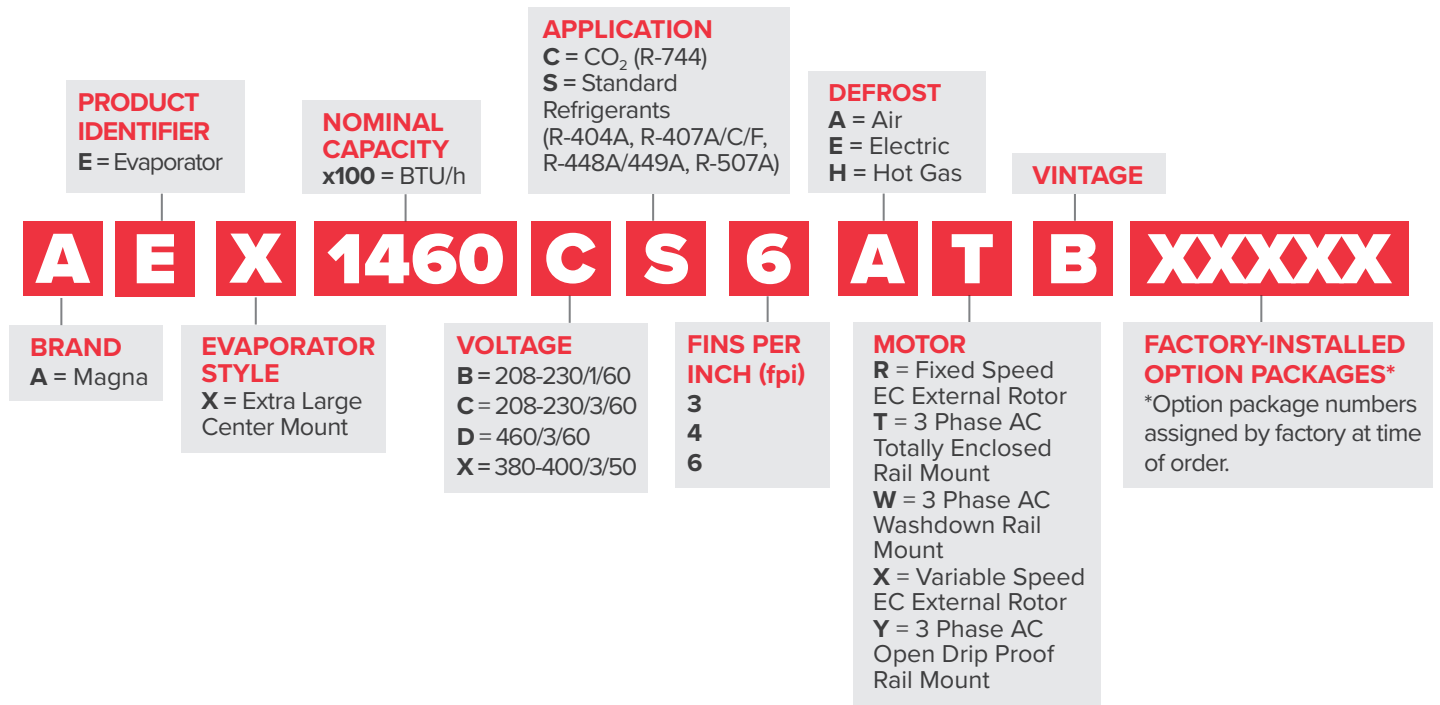

Table 1: Capacity Correction Factors

Electric and Hot Gas Defrost Units Only											
Saturated Suction Temperature	-40°F (-40°C)	-30°F (-34°C)	-20°F (-29°C)	-10°F (-23°C)	0°F (-18°C)	10°F (-12°C)	20°F (-7°C)	25°F (-4°C)	30°F (-1°C)	40°F (4°C)	45°F (7°C)
Multiply Capacity By	0.54	0.61	0.68	0.75	0.82	0.89	0.98	1	1.03	1.1	1.14

Notes:

^ = Correction factors provided for reference only. Contact Heatcraft sales representative for capacity information at required conditions.

PERFORMANCE DATA

Magna Simulation Capacity: Air Defrost- 60 Hz

		Magna Simulation Capacity				Fan Data			Air Throw Per Side
		R-404A/R-507A		R-448A/R-449A					
		Model	10°F TD/25°F SST 80% RH BTUH	6°C TD/-4°C SST 80% RH Watts	10°F TD/25°F SST 80% RH BTUH	6°C TD/-4°C SST 80% RH Watts	No. of Fans	CFM	m³H
4 Fins Per Inch	AEX0390*S4A^B	20,711	6,070	29,313	8,591	1	3,750	6,371	25
	AEX0580*S4A^B	34,292	10,050	46,401	13,599	2	7,500	12,743	25
	AEX0675*S4A^B	41,116	12,050	58,900	17,262	2	7,500	12,743	25
	AEX1050*S4A^B	61,316	17,970	88,805	26,026	3	11,250	19,114	25
	AEX1110*S4A^B	66,400	19,460	94,738	27,765	4	15,000	25,485	25
	AEX1385*S4A^B	81,277	23,820	117,766	34,514	4	15,000	25,485	25
	AEX1460*S4A^B	84,928	24,890	118,239	34,652	5	18,750	31,856	25
6 Fins Per Inch	AEX0475*S6A^B	24,465	7,170	33,629	9,856	1	3,750	6,371	25
	AEX0700*S6A^B	40,877	11,980	56,856	16,663	2	7,500	12,743	25
	AEX0805*S6A^B	47,258	13,850	69,307	20,312	2	7,500	12,743	25
	AEX1225*S6A^B	70,324	20,610	103,930	30,459	3	11,250	19,114	25
	AEX1315*S6A^B	82,232	24,100	113,189	33,172	4	15,000	25,485	25
	AEX1605*S6A^B	93,117	27,290	137,852	40,400	4	15,000	25,485	25
	AEX1765*S6A^B	100,009	29,310	142,025	41,623	5	18,750	31,856	25

Notes:

* = Voltage (see Nomenclature details)

^ = Motor Code Designator (see Nomenclature details)

PERFORMANCE DATA

Magna Simulation Capacity: Air Defrost- 60 Hz

		Magna Simulation Capacity				Fan Data			Air Throw Per Side
		R-407A/R-407F		R-407C					
		10°F TD/25°F SST 80% RH	6°C TD/-4°C SST 80% RH	10°F TD/25°F SST 80% RH	6°C TD/-4°C SST 80% RH	No. of Fans	CFM	m³H	
Model	BTUH	Watts	BTUH	Watts				Standard	
4 Fins Per Inch	AEX0390*S4A^B	25,889	7,587	30,026	8,800	1	3,750	6,371	25
	AEX0580*S4A^B	42,865	12,562	49,134	14,400	2	7,500	12,743	25
	AEX0675*S4A^B	51,395	15,062	59,200	17,350	2	7,500	12,743	25
	AEX1050*S4A^B	76,645	22,462	87,828	25,740	3	11,250	19,114	25
	AEX1110*S4A^B	83,000	24,325	93,526	27,410	4	15,000	25,485	25
	AEX1385*S4A^B	101,596	29,775	116,524	34,150	4	15,000	25,485	25
	AEX1460*S4A^B	106,160	31,112	120,550	35,330	5	18,750	31,856	25
6 Fins Per Inch	AEX0475*S6A^B	30,581	8,962	36,305	10,640	1	3,750	6,371	25
	AEX0700*S6A^B	51,096	14,975	58,893	17,260	2	7,500	12,743	25
	AEX0805*S6A^B	59,073	17,312	68,652	20,120	2	7,500	12,743	25
	AEX1225*S6A^B	87,905	25,762	101,408	29,720	3	11,250	19,114	25
	AEX1315*S6A^B	102,790	30,125	118,640	34,770	4	15,000	25,485	25
	AEX1605*S6A^B	116,396	34,112	133,585	39,150	4	15,000	25,485	25
	AEX1765*S6A^B	125,011	36,637	142,525	41,770	5	18,750	31,856	25

Notes:

* = Voltage (see Nomenclature details)

^ = Motor Code Designator (see Nomenclature details)

PERFORMANCE DATA

Magna Simulation Capacity: Air Defrost- 50 Hz

		Magna Simulation Capacity				Fan Data			Air Throw Per Side
		R-404A/R-507A		R-448A/R-449A					
		Model	10°F TD/25°F SST 80% RH BTUH	6°C TD/-4°C SST 80% RH Watts	10°F TD/25°F SST 80% RH BTUH	6°C TD/-4°C SST 80% RH Watts	No. of Fans	CFM	m³H
4 Fins Per Inch	AEX0390*S4A^B	20,711	6,070	29,313	8,591	1	3,750	6,371	25
	AEX0580*S4A^B	34,292	10,050	46,401	13,599	2	7,500	12,743	25
	AEX0675*S4A^B	41,116	12,050	58,900	17,262	2	7,500	12,743	25
	AEX1050*S4A^B	61,316	17,970	88,805	26,026	3	11,250	19,114	25
	AEX1110*S4A^B	66,400	19,460	94,738	27,765	4	15,000	25,485	25
	AEX1385*S4A^B	81,277	23,820	117,766	34,514	4	15,000	25,485	25
	AEX1460*S4A^B	84,928	24,890	118,239	34,652	5	18,750	31,856	25
6 Fins Per Inch	AEX0475*S6A^B	24,465	7,170	33,629	9,856	1	3,750	6,371	25
	AEX0700*S6A^B	40,877	11,980	56,856	16,663	2	7,500	12,743	25
	AEX0805*S6A^B	47,258	13,850	69,307	20,312	2	7,500	12,743	25
	AEX1225*S6A^B	70,324	20,610	103,930	30,459	3	11,250	19,114	25
	AEX1315*S6A^B	82,232	24,100	113,189	33,172	4	15,000	25,485	25
	AEX1605*S6A^B	93,117	27,290	137,852	40,400	4	15,000	25,485	25
	AEX1765*S6A^B	100,009	29,310	142,025	41,623	5	18,750	31,856	25

Notes:

* = Voltage (see Nomenclature details)

^ = Motor Code Designator (see Nomenclature details)

PERFORMANCE DATA

Magna Simulation Capacity: Air Defrost- 50 Hz

		Magna Simulation Capacity				Fan Data			Air Throw Per Side
		R-407A/R-407F		R-407C					
		10°F TD/25°F SST 80% RH	6°C TD/-4°C SST 80% RH	10°F TD/25°F SST 80% RH	6°C TD/-4°C SST 80% RH	No. of Fans	CFM	m³H	
Model	BTUH	Watts	BTUH	Watts				Standard	
4 Fins Per Inch	AEX0390*S4A^B	25,889	7,587	30,026	8,800	1	3,750	6,371	25
	AEX0580*S4A^B	42,865	12,562	49,134	14,400	2	7,500	12,743	25
	AEX0675*S4A^B	51,395	15,062	59,200	17,350	2	7,500	12,743	25
	AEX1050*S4A^B	76,645	22,462	87,828	25,740	3	11,250	19,114	25
	AEX1110*S4A^B	83,000	24,325	93,526	27,410	4	15,000	25,485	25
	AEX1385*S4A^B	101,596	29,775	116,524	34,150	4	15,000	25,485	25
	AEX1460*S4A^B	106,160	31,112	120,550	35,330	5	18,750	31,856	25
6 Fins Per Inch	AEX0475*S6A^B	30,581	8,962	36,305	10,640	1	3,750	6,371	25
	AEX0700*S6A^B	51,096	14,975	58,893	17,260	2	7,500	12,743	25
	AEX0805*S6A^B	59,073	17,312	68,652	20,120	2	7,500	12,743	25
	AEX1225*S6A^B	87,905	25,762	101,408	29,720	3	11,250	19,114	25
	AEX1315*S6A^B	102,790	30,125	118,640	34,770	4	15,000	25,485	25
	AEX1605*S6A^B	116,396	34,112	133,585	39,150	4	15,000	25,485	25
	AEX1765*S6A^B	125,011	36,637	142,525	41,770	5	18,750	31,856	25

Notes:

* = Voltage (see Nomenclature details)

^ = Motor Code Designator (see Nomenclature details)

SPECIFICATIONS

Air Defrost- 60 Hz

Fixed Speed EC External Rotor & Variable Speed EC External Rotor Motors

		208-230/1/60						430/3/60			
	Model	No. of Fans	HP	Amps	Watts	MCA	MOPD	Amps	Watts	MCA	MOPD
4 Fins Per Inch	AEX0390*S4A^B	1	1	3.3	740	4.1	15	1.5	960	1.9	15
	AEX0580*S4A^B	2	1	6.6	1,480	7.3	15	3.0	1,920	3.4	15
	AEX0675*S4A^B	2	1	6.6	1,480	7.3	15	3.0	1,920	3.4	15
	AEX1050*S4A^B	3	1	9.9	2,220	7.3	15	4.5	2,880	4.9	15
	AEX1110*S4A^B	4	1	13.2	2,960	10.6	15	6.0	3,840	6.4	15
	AEX1385*S4A^B	4	1	13.2	2,960	10.6	15	6.0	3,840	6.4	15
	AEX1460*S4A^B	5	1	16.5	3,700	13.8	15	7.5	4,800	7.9	15
6 Fins Per Inch	AEX0475*S6A^B	1	1	3.3	740	4.1	15	1.5	960	1.9	15
	AEX0700*S6A^B	2	1	6.6	1,480	7.3	15	3.0	1,920	3.4	15
	AEX0805*S6A^B	2	1	6.6	1,480	7.3	15	3.0	1,920	3.4	15
	AEX1225*S6A^B	3	1	9.9	2,220	7.3	15	4.5	2,880	4.9	15
	AEX1315*S6A^B	4	1	13.2	2,960	10.6	15	6.0	3,840	6.4	15
	AEX1605*S6A^B	4	1	13.2	2,960	10.6	15	6.0	3,840	6.4	15
	AEX1765*S6A^B	5	1	15	3,700	13.8	15	7.5	4,800	7.9	15

3 Phase AC Totally Enclosed Rail Motors

		208-230/3/60						430/3/60			
	Model	No. of Fans	HP	Amps	Watts	MCA	MOPD	Amps	Watts	MCA	MOPD
4 Fins Per Inch	AEX0390*S4ATB	1	3/4	3.5	600	4.4	15	1.7	600	2.1	15
	AEX0580*S4ATB	2	3/4	7.0	1,200	7.9	15	3.4	1,200	3.8	15
	AEX0675*S4ATB	2	3/4	7.0	1,200	7.9	15	3.4	1,200	3.8	15
	AEX1050*S4ATB	3	3/4	10.5	1,800	11.4	15	5.1	1,800	5.5	15
	AEX1110*S4ATB	4	3/4	14.0	2,400	14.9	15	6.8	2,400	7.2	15
	AEX1385*S4ATB	4	3/4	14.0	2,400	14.9	15	6.8	2,400	7.2	15
	AEX1460*S4ATB	5	3/4	17.5	3,000	18.4	20	8.5	3,000	8.9	15
6 Fins Per Inch	AEX0475*S6ATB	1	3/4	3.5	600	4.4	15	1.7	600	2.1	15
	AEX0700*S6ATB	2	3/4	7.0	1,200	7.9	15	3.4	1,200	3.8	15
	AEX0805*S6ATB	2	3/4	7.0	1,200	7.9	15	3.4	1,200	3.8	15
	AEX1225*S6ATB	3	3/4	10.5	1,800	11.4	15	5.1	1,800	5.5	15
	AEX1315*S6ATB	4	3/4	14.0	2,400	14.9	15	6.8	2,400	7.2	15
	AEX1605*S6ATB	4	3/4	14.0	2,400	14.9	15	6.8	2,400	7.2	15
	AEX1765*S6ATB	5	3/4	17.5	3,000	18.4	20	8.5	3,000	8.9	15

Notes:

* = Voltage (see Nomenclature details)

^ = Motor Code Designator (see Nomenclature details)

SPECIFICATIONS

Air Defrost- 60 Hz

		3 Phase AC Open Drip Proof Rail Mount Motors									
		208-230/3/60					430/3/60				
	Model	No. of Fans	HP	Amps	Watts	MCA	MOPD	Amps	Watts	MCA	MOPD
4 Fins Per Inch	AEX0390*S4AYB	1	3/4	3.0	600	3.8	15	1.5	600	1.9	15
	AEX0580*S4AYB	2	3/4	6.0	1,200	6.8	15	3.0	1,200	3.4	15
	AEX0675*S4AYB	2	3/4	6.0	1,200	6.8	15	3.0	1,200	3.4	15
	AEX1050*S4AYB	3	3/4	9.0	1,800	9.8	15	4.5	1,800	4.9	15
	AEX1110*S4AYB	4	3/4	12.0	2,400	12.8	15	6.0	2,400	6.4	15
	AEX1385*S4AYB	4	3/4	12.0	2,400	12.8	15	6.0	2,400	6.4	15
6 Fins Per Inch	AEX1460*S4AYB	5	3/4	15.0	3,000	15.8	20	7.5	3,000	7.9	15
	AEX0475*S6AYB	1	3/4	3.0	600	3.8	15	1.5	600	1.9	15
	AEX0700*S6AYB	2	3/4	6.0	1,200	6.8	15	3.0	1,200	3.4	15
	AEX0805*S6AYB	2	3/4	6.0	1,200	6.8	15	3.0	1,200	3.4	15
	AEX1225*S6AYB	3	3/4	9.0	1,800	9.8	15	4.5	1,800	4.9	15
	AEX1315*S6AYB	4	3/4	12.0	2,400	12.8	15	6.0	2,400	6.4	15
AEX1605*S6AYB	4	3/4	12.0	2,400	12.8	15	6.0	2,400	6.4	15	
AEX1765*S6AYB	5	3/4	15.0	3,000	15.8	20	7.5	3,000	7.9	15	

		3 Phase AC Washdown Rail Motors									
		208-230/3/60					430/3/60				
	Model	No. of Fans	HP	Amps	Watts	MCA	MOPD	Amps	Watts	MCA	MOPD
4 Fins Per Inch	AEX0390*S4AWB	1	3/4	3.2	600	4.0	15	1.6	600	2.0	15
	AEX0580*S4AWB	2	3/4	6.4	1,200	7.2	15	3.2	1,200	3.6	15
	AEX0675*S4AWB	2	3/4	6.4	1,200	7.2	15	3.2	1,200	3.6	15
	AEX1050*S4AWB	3	3/4	9.6	1,800	10.4	15	4.8	1,800	5.2	15
	AEX1110*S4AWB	4	3/4	12.8	2,400	13.6	15	6.4	2,400	6.8	15
	AEX1385*S4AWB	4	3/4	12.8	2,400	13.6	15	6.4	2,400	6.8	15
6 Fins Per Inch	AEX1460*S4AWB	5	3/4	16.0	3,000	16.8	20	8.0	3,000	8.4	15
	AEX0475*S6AWB	1	3/4	3.2	600	4.0	15	1.6	600	2.0	15
	AEX0700*S6AWB	2	3/4	6.4	1,200	7.2	15	3.2	1,200	3.6	15
	AEX0805*S6AWB	2	3/4	6.4	1,200	7.2	15	3.2	1,200	3.6	15
	AEX1225*S6AWB	3	3/4	9.6	1,800	10.4	15	4.8	1,800	5.2	15
	AEX1315*S6AWB	4	3/4	12.8	2,400	13.6	15	6.4	2,400	6.8	15
AEX1605*S6AWB	4	3/4	12.8	2,400	13.6	15	6.4	2,400	6.8	15	
AEX1765*S6AWB	5	3/4	16.0	3,000	16.8	20	8.0	3,000	8.4	15	

Notes:

* = Voltage (see Nomenclature details)

SPECIFICATIONS

Air Defrost- 50 Hz

		380-400/3/50									
		3 Phase AC Totally Enclosed Rail Mount Motors						3 Phase AC Open Drip Proof Rail Mount Motors			
	Model	No. of Fans	HP	Amps	Watts	MCA	MOPD	Amps	Watts	MCA	MOPD
4 Fins Per Inch	AEX0390XS4A^B	1	3/4	1.7	600	2.1	15	1.5	600	1.9	15
	AEX0580XS4A^B	2	3/4	3.4	1,200	3.8	15	3.0	1,200	3.4	15
	AEX0675XS4A^B	2	3/4	3.4	1,200	3.8	15	3.0	1,200	3.4	15
	AEX1050XS4A^B	3	3/4	5.1	1,800	5.5	15	4.5	1,800	4.9	15
	AEX1110XS4A^B	4	3/4	6.8	2,400	7.2	15	6.0	2,400	6.4	15
	AEX1385XS4A^B	4	3/4	6.8	2,400	7.2	15	6.0	2,400	6.4	15
	AEX1460XS4A^B	5	3/4	8.5	3,000	8.9	15	7.5	3,000	7.9	15
6 Fins Per Inch	AEX0475XS6A^B	1	3/4	2.1	600	2.1	15	1.5	600	1.9	15
	AEX0700XS6A^B	2	3/4	3.8	1,200	3.8	15	3.0	1,200	3.4	15
	AEX0805XS6A^B	2	3/4	3.8	1,200	3.8	15	3.0	1,200	3.4	15
	AEX1225XS6A^B	3	3/4	5.5	1,800	5.5	15	4.5	1,800	4.9	15
	AEX1315XS6A^B	4	3/4	7.2	2,400	7.2	15	6.0	2,400	6.4	15
	AEX1605XS6A^B	4	3/4	7.2	2,400	7.2	15	6.0	2,400	6.4	15
	AEX1765XS6A^B	5	3/4	8.9	3,000	8.9	15	7.5	3,000	7.9	15

		380-400/3/50										
		3 Phase AC Washdown Rail Mount Motors						Fixed Speed EC External Rotor & Variable Speed EC External Rotor Motors				
	Model	No. of Fans	HP	Amps	Watts	MCA	MOPD	HP	Amps	Watts	MCA	MOPD
4 Fins Per Inch	AEX0390XS4A^B	1	3/4	1.6	600	2.0	15	1	1.5	960	1.9	15
	AEX0580XS4A^B	2	3/4	3.2	1,200	3.6	15	1	3.0	1,920	3.4	15
	AEX0675XS4A^B	2	3/4	3.2	1,200	3.6	15	1	3.0	1,920	3.4	15
	AEX1050XS4A^B	3	3/4	4.8	1,800	5.2	15	1	4.5	2,880	4.9	15
	AEX1110XS4A^B	4	3/4	6.4	2,400	6.8	15	1	6.0	3,840	6.4	15
	AEX1385XS4A^B	4	3/4	6.4	2,400	6.8	15	1	6.0	3,840	6.4	15
	AEX1460XS4A^B	5	3/4	8.0	3,000	8.4	15	1	7.5	4,800	7.9	15
6 Fins Per Inch	AEX0475XS6A^B	1	3/4	1.6	600	2.0	15	1	1.5	960	1.9	15
	AEX0700XS6A^B	2	3/4	3.2	1,200	3.6	15	1	3.0	1,920	3.4	15
	AEX0805XS6A^B	2	3/4	3.2	1,200	3.6	15	1	3.0	1,920	3.4	15
	AEX1225XS6A^B	3	3/4	4.8	1,800	5.2	15	1	4.5	2,880	4.9	15
	AEX1315XS6A^B	4	3/4	6.4	2,400	6.8	15	1	6.0	3,840	6.4	15
	AEX1605XS6A^B	4	3/4	6.4	2,400	6.8	15	1	6.0	3,840	6.4	15
	AEX1765XS6A^B	5	3/4	8.0	3,000	8.4	15	1	7.5	4,800	7.9	15

Notes:

^ = Motor Code Designator (see Nomenclature details)

PERFORMANCE DATA

Magna Simulation Capacity: Electric Defrost- 60 Hz

		Magna Simulation Capacity				Fan Data			Air Throw Per Side
		R-404A/R-507A		R-448A/R-449A					
		Model	10°F TD/25°F SST 80% RH BTUH	6°C TD/-4°C SST 80% RH Watts	10°F TD/25°F SST 80% RH BTUH	6°C TD/-4°C SST 80% RH Watts	No. of Fans	CFM	m³H
3 Fins Per Inch	AEX0325*S3E^B	17,679	5,181	24,552	7,195	1	3,750	6,371	25
	AEX0505*S3E^B	30,793	9,025	40,774	11,950	2	7,500	12,743	25
	AEX0595*S3E^B	38,598	11,312	51,631	15,132	2	7,500	12,743	25
	AEX0930*S3E^B	54,940	16,101	78,014	22,864	3	11,250	19,114	25
	AEX0975*S3E^B	60,428	17,710	82,558	24,195	4	15,000	25,485	25
	AEX1230*S3E^B	74,497	21,833	103,425	30,311	4	15,000	25,485	25
	AEX1620*S3E^B	98,106	28,752	127,796	37,453	5	18,750	31,856	25
4 Fins Per Inch	AEX0390*S4E^B	20,711	6,070	29,313	8,591	1	3,750	6,371	25
	AEX0580*S4E^B	34,292	10,050	46,401	13,599	2	7,500	12,743	25
	AEX0675*S4E^B	41,116	12,050	58,900	17,262	2	7,500	12,743	25
	AEX1050*S4E^B	61,316	17,970	88,805	26,026	3	11,250	19,114	25
	AEX1110*S4E^B	66,400	19,460	94,738	27,765	4	15,000	25,485	25
	AEX1385*S4E^B	81,277	23,820	117,766	34,514	4	15,000	25,485	25
	AEX1460*S4E^B	84,928	24,890	118,239	34,652	5	18,750	31,856	25
6 Fins Per Inch	AEX0475*S6E^B	24,465	7,170	33,629	9,856	1	3,750	6,371	25
	AEX0700*S6E^B	40,877	11,980	56,856	16,663	2	7,500	12,743	25
	AEX0805*S6E^B	47,258	13,850	69,307	20,312	2	7,500	12,743	25
	AEX1225*S6E^B	70,324	20,610	103,930	30,459	3	11,250	19,114	25
	AEX1315*S6E^B	82,232	24,100	113,189	33,172	4	15,000	25,485	25
	AEX1605*S6E^B	93,117	27,290	137,852	40,400	4	15,000	25,485	25
	AEX1765*S6E^B	100,009	29,310	142,025	41,623	5	18,750	31,856	25

Notes:

* = Voltage (see Nomenclature details)

^ = Motor Code Designator (see Nomenclature details)

PERFORMANCE DATA

Magna Simulation Capacity: Electric Defrost- 60 Hz

		Magna Simulation Capacity				Fan Data			Air Throw Per Side
		R-407A / R-407F		R-407C					
		Model	10°F TD/25°F SST 80% RH	6°C TD/-4°C SST 80% RH	10°F TD/25°F SST 80% RH	6°C TD/-4°C SST 80% RH	No. of Fans	CFM	m³H
3 Fins Per Inch	AEX0325*S3E^B	22,099	6,477	23,905	7,006	1	3,750	6,371	25
	AEX0505*S3E^B	38,491	11,281	40,438	11,851	2	7,500	12,743	25
	AEX0595*S3E^B	48,248	14,140	51,557	15,110	2	7,500	12,743	25
	AEX0930*S3E^B	68,675	20,127	77,247	22,639	3	11,250	19,114	25
	AEX0975*S3E^B	75,535	22,137	82,049	24,046	4	15,000	25,485	25
	AEX1230*S3E^B	93,121	27,291	102,825	30,135	4	15,000	25,485	25
	AEX1620*S3E^B	122,633	35,940	126,758	37,149	5	18,750	31,856	25
4 Fins Per Inch	AEX0390*S4E^B	25,889	7,587	30,026	8,800	1	3,750	6,371	25
	AEX0580*S4E^B	42,865	12,562	49,134	14,400	2	7,500	12,743	25
	AEX0675*S4E^B	51,395	15,062	59,200	17,350	2	7,500	12,743	25
	AEX1050*S4E^B	76,645	22,462	87,828	25,740	3	11,250	19,114	25
	AEX1110*S4E^B	83,000	24,325	93,526	27,410	4	15,000	25,485	25
	AEX1385*S4E^B	101,596	29,775	116,524	34,150	4	15,000	25,485	25
	AEX1460*S4E^B	106,160	31,112	120,550	35,330	5	18,750	31,856	25
6 Fins Per Inch	AEX0475*S6E^B	30,581	8,962	36,305	10,640	1	3,750	6,371	25
	AEX0700*S6E^B	51,096	14,975	58,893	17,260	2	7,500	12,743	25
	AEX0805*S6E^B	59,073	17,312	68,652	20,120	2	7,500	12,743	25
	AEX1225*S6E^B	87,905	25,762	101,408	29,720	3	11,250	19,114	25
	AEX1315*S6E^B	102,790	30,125	118,640	34,770	4	15,000	25,485	25
	AEX1605*S6E^B	116,396	34,112	133,585	39,150	4	15,000	25,485	25
	AEX1765*S6E^B	125,011	36,637	142,525	41,770	5	18,750	31,856	25

Notes:

* = Voltage (see Nomenclature details)

^ = Motor Code Designator (see Nomenclature details)

PERFORMANCE DATA

Magna Simulation Capacity: Electric Defrost- 50 Hz

		Magna Simulation Capacity				Fan Data			Air Throw Per Side
		R-404A/R-507A		R-448A/R-449A					
		Model	10°F TD/25°F SST 80% RH BTUH	6°C TD/-4°C SST 80% RH Watts	10°F TD/25°F SST 80% RH BTUH	6°C TD/-4°C SST 80% RH Watts	No. of Fans	CFM	m³H
3 Fins Per Inch	AEX0325*S3E^B	17,679	5,181	24,552	7,195	1	3,050	5,182	25
	AEX0505*S3E^B	30,793	9,025	40,774	119,50	2	6,100	10,364	25
	AEX0595*S3E^B	38,598	11,312	51,631	15,132	2	6,100	10,364	25
	AEX0930*S3E^B	54,940	16,101	78,014	22,864	3	9,150	15,546	25
	AEX0975*S3E^B	60,428	17,710	82,558	24,195	4	12,200	20,728	25
	AEX1230*S3E^B	74,497	21,833	103,425	30,311	4	12,200	20,728	25
	AEX1620*S3E^B	98,106	28,752	127,796	37,453	5	15,250	25,910	25
4 Fins Per Inch	AEX0390*S4E^B	20,711	6,070	29,313	8,591	1	3,050	5,182	25
	AEX0580*S4E^B	34,292	10,050	46,401	13,599	2	6,100	10,364	25
	AEX0675*S4E^B	41,116	12,050	58,900	17,262	2	6,100	10,364	25
	AEX1050*S4E^B	61,316	17,970	88,805	26,026	3	9,150	15,546	25
	AEX1110*S4E^B	66,400	19,460	94,738	27,765	4	12,200	20,728	25
	AEX1385*S4E^B	81,277	23,820	117,766	34,514	4	12,200	20,728	25
	AEX1460*S4E^B	84,928	24,890	118,239	34,652	5	15,250	25,910	25
6 Fins Per Inch	AEX0475*S6E^B	24,465	7,170	33,629	9,856	1	3,050	5,182	25
	AEX0700*S6E^B	40,877	11,980	56,856	16,663	2	6,100	10,364	25
	AEX0805*S6E^B	47,258	13,850	69,307	20,312	2	6,100	10,364	25
	AEX1225*S6E^B	70,324	20,610	103,930	30,459	3	9,150	15,546	25
	AEX1315*S6E^B	82,232	24,100	113,189	33,172	4	12,200	20,728	25
	AEX1605*S6E^B	93,117	27,290	137,852	40,400	4	12,200	20,728	25
	AEX1765*S6E^B	100,009	29,310	142,025	41,623	5	15,250	25,910	25

Notes:

* = Voltage (see Nomenclature details)

^ = Motor Code Designator (see Nomenclature details)

PERFORMANCE DATA

Magna Simulation Capacity: Electric Defrost- 50 Hz

		Magna Simulation Capacity				Fan Data			Air Throw Per Side
		R-407A / R-407F		R-407C					
		Model	10°F TD/25°F SST 80% RH BTUH	6°C TD/-4°C SST 80% RH Watts	10°F TD/25°F SST 80% RH BTUH	6°C TD/-4°C SST 80% RH Watts	No. of Fans	CFM	m³H
3 Fins Per Inch	AEX0325*S3E^B	22,099	6,477	23,905	7,006	1	3,050	5,182	25
	AEX0505*S3E^B	38,491	11,281	40,438	11,851	2	6,100	10,364	25
	AEX0595*S3E^B	48,248	14,140	51,557	15,110	2	6,100	10,364	25
	AEX0930*S3E^B	68,675	20,127	77,247	22,639	3	9,150	15,546	25
	AEX0975*S3E^B	75,535	22,137	82,049	24,046	4	12,200	20,728	25
	AEX1230*S3E^B	93,121	27,291	102,825	30,135	4	12,200	20,728	25
	AEX1620*S3E^B	122,633	35,940	126,758	37,149	5	15,250	25,910	25
4 Fins Per Inch	AEX0390*S4E^B	25,889	7,587	30,026	8,800	1	3,050	5,182	25
	AEX0580*S4E^B	42,865	12,562	49,134	14,400	2	6,100	10,364	25
	AEX0675*S4E^B	51,395	15,062	59,200	17,350	2	6,100	10,364	25
	AEX1050*S4E^B	76,643	22,462	87,828	25,740	3	9,150	15,546	25
	AEX1110*S4E^B	83,000	24,325	93,526	27,410	4	12,200	20,728	25
	AEX1385*S4E^B	101,596	29,775	116,524	34,150	4	12,200	20,728	25
	AEX1460*S4E^B	106,160	31,112	120,550	35,330	5	15,250	25,910	25
6 Fins Per Inch	AEX0475*S6E^B	30,581	8,962	36,305	10,640	1	3,050	5,182	25
	AEX0700*S6E^B	51,096	14,975	58,893	17,260	2	6,100	10,364	25
	AEX0805*S6E^B	59,073	17,312	68,652	20,120	2	6,100	10,364	25
	AEX1225*S6E^B	87,905	25,762	101,408	29,720	3	9,150	15,546	25
	AEX1315*S6E^B	102,790	30,125	118,640	34,770	4	12,200	20,728	25
	AEX1605*S6E^B	116,396	34,112	133,585	39,150	4	12,200	20,728	25
	AEX1765*S6E^B	125,011	36,637	142,525	41,770	5	15,250	25,910	25

Notes:

* = Voltage (see Nomenclature details)

^ = Motor Code Designator (see Nomenclature details)

SPECIFICATIONS

Electric Defrost- 60 Hz

	Model	No. of Fans	HP	Fixed Speed EC External Rotor & Variable Speed EC External Rotor Motors				Defrost Heaters			
				Amps	Watts	MCA	MOPD	No. of Heaters	Total Watts	230V/3/60 Hz	460V/3/60 Hz
										Total Amps	
3 Fins Per Inch	AEX0325*S3E^B	1	1	3.3	740	4.1	15	6	5,700	14.3	7.2
	AEX0505*S3E^B	2	1	6.6	1,480	7.3	15	6	10,200	25.6	12.8
	AEX0595*S3E^B	2	1	6.6	1,480	7.3	15	6	10,200	25.6	12.8
	AEX0930*S3E^B	3	1	9.9	2,220	7.3	15	6	15,300	38.4	19.2
	AEX0975*S3E^B	4	1	13.2	2,960	10.6	15	6	19,800	49.7	24.9
	AEX1230*S3E^B	4	1	13.2	2,960	10.6	15	6	19,800	49.7	24.9
	AEX1620*S3E^B	5	1	16.5	3,700	13.8	15	6	34,200	85.9	42.9
4 Fins Per Inch	AEX0390*S4E^B	1	1	3.3	740	4.1	15	6	5,700	14.3	7.2
	AEX0580*S4E^B	2	1	6.6	1,480	7.3	15	6	10,200	25.6	12.8
	AEX0675*S4E^B	2	1	6.6	1,480	7.3	15	6	10,200	25.6	12.8
	AEX1050*S4E^B	3	1	9.9	2,220	7.3	15	6	15,300	38.4	19.2
	AEX1110*S4E^B	4	1	13.2	2,960	10.6	15	6	19,800	49.7	24.9
	AEX1385*S4E^B	4	1	13.2	2,960	10.6	15	6	19,800	49.7	24.9
	AEX1460*S4E^B	5	1	16.5	3,700	13.8	15	6	34,200	85.9	42.9
6 Fins Per Inch	AEX0475*S6E^B	1	1	3.3	740	4.1	15	6	5,700	14.3	7.2
	AEX0700*S6E^B	2	1	6.6	1,480	7.3	15	6	10,200	25.6	12.8
	AEX0805*S6E^B	2	1	6.6	1,480	7.3	15	6	10,200	25.6	12.8
	AEX1225*S6E^B	3	1	9.9	2,220	7.3	15	6	15,300	38.4	19.2
	AEX1315*S6E^B	4	1	13.2	2,960	10.6	15	6	19,800	49.7	24.9
	AEX1605*S6E^B	4	1	13.2	2,960	10.6	15	6	19,800	49.7	24.9
	AEX1765*S6E^B	5	1	16.5	3,700	13.8	15	6	34,200	85.9	42.9

Notes:

* = Voltage (see Nomenclature details)

^ = Motor Code Designator (see Nomenclature details)

SPECIFICATIONS

Electric Defrost- 60 Hz

		Fixed Speed EC External Rotor & Variable Speed EC External Rotor Motors						Defrost Heaters			
		460/3/60						No. of Heaters	Total Watts	230V/3/60 Hz	460V/3/60 Hz
Model	No. of Fans	HP	Amps	Watts	MCA	MOPD	Total Amps				
3 Fins Per Inch	AEX0325*S3E^B	1	1	1.5	960	1.9	15	6	5,700	14.3	7.2
	AEX0505*S3E^B	2	1	3.0	1,920	3.4	15	6	10,200	25.6	12.8
	AEX0595*S3E^B	2	1	3.0	1,920	3.4	15	6	10,200	25.6	12.8
	AEX0930*S3E^B	3	1	4.5	2,880	4.9	15	6	15,300	38.4	19.2
	AEX0975*S3E^B	4	1	6.0	3,840	6.4	15	6	19,800	49.7	24.9
	AEX1230*S3E^B	4	1	6.0	3,840	6.4	15	6	19,800	49.7	24.9
	AEX1620*S3E^v	5	1	7.5	4,800	7.9	15	6	34,200	85.9	42.9
4 Fins Per Inch	AEX0390*S4E^B	1	1	1.5	960	1.9	15	6	5,700	14.3	7.2
	AEX0580*S4E^B	2	1	3.0	1,920	3.4	15	6	10,200	25.6	12.8
	AEX0675*S4E^B	2	1	3.0	1,920	3.4	15	6	10,200	25.6	12.8
	AEX1050*S4E^B	3	1	4.5	2,880	4.9	15	6	15,300	38.4	19.2
	AEX1110*S4E^B	4	1	6.0	3,840	6.4	15	6	19,800	49.7	24.9
	AEX1385*S4E^B	4	1	6.0	3,840	6.4	15	6	19,800	49.7	24.9
	AEX1460*S4E^B	5	1	7.5	4,800	7.9	15	6	34,200	85.9	42.9
6 Fins Per Inch	AEX0475*S6E^B	1	1	1.5	960	1.9	15	6	5,700	14.3	7.2
	AEX0700*S6E^B	2	1	3.0	1,920	3.4	15	6	10,200	25.6	12.8
	AEX0805*S6E^B	2	1	3.0	1,920	3.4	15	6	10,200	25.6	12.8
	AEX1225*S6E^B	3	1	4.5	2,880	4.9	15	6	15,300	38.4	19.2
	AEX1315*S6E^B	4	1	6.0	3,840	6.4	15	6	19,800	49.7	24.9
	AEX1605*S6E^B	4	1	6.0	3,840	6.4	15	6	19,800	49.7	24.9
	AEX1765*S6E^B	5	1	7.5	4,800	7.9	15	6	34,200	85.9	42.9

Notes:

* = Voltage (see Nomenclature details)

^ = Motor Code Designator (see Nomenclature details)

SPECIFICATIONS

Electric Defrost- 60 Hz

	Model	No. of Fans	HP	3 Phase AC Totally Enclosed Rail Mount Motors				Defrost Heaters			
				Amps	Watts	MCA	MOPD	No. of Heaters	Total Watts	230V/3/60 Hz	460V/3/60 Hz
										Total Amps	
3 Fins Per Inch	AEX0325*S3ETB	1	3/4	3.5	600	4.4	15	6	5,700	14.3	7.2
	AEX0505*S3ETB	2	3/4	7.0	1,200	7.9	15	6	10,200	25.6	12.8
	AEX0595*S3ETB	2	3/4	7.0	1,200	7.9	15	6	10,200	25.6	12.8
	AEX0930*S3ETB	3	3/4	10.5	1,800	11.4	15	6	15,300	38.4	19.2
	AEX0975*S3ETB	4	3/4	14.0	2,400	14.9	15	6	19,800	49.7	24.9
	AEX1230*S3ETB	4	3/4	14.0	2,400	14.9	15	6	19,800	49.7	24.9
	AEX1620*S3ETB	5	3/4	17.5	3,000	18.4	20	6	34,200	85.9	42.9
4 Fins Per Inch	AEX0390*S4ETB	1	3/4	3.5	600	4.4	15	6	5,700	14.3	7.2
	AEX0580*S4ETB	2	3/4	7.0	1,200	7.9	15	6	10,200	25.6	12.8
	AEX0675*S4ETB	2	3/4	7.0	1,200	7.9	15	6	10,200	25.6	12.8
	AEX1050*S4ETB	3	3/4	10.5	1,800	11.4	15	6	15,300	38.4	19.2
	AEX1110*S4ETB	4	3/4	14.0	2,400	14.9	15	6	19,800	49.7	24.9
	AEX1385*S4ETB	4	3/4	14.0	2,400	14.9	15	6	19,800	49.7	24.9
	AEX1460*S4ETB	5	3/4	17.5	3,000	18.4	20	6	34,200	85.9	42.9
6 Fins Per Inch	AEX0475*S6ETB	1	3/4	3.5	600	4.4	15	6	5,700	14.3	7.2
	AEX0700*S6ETB	2	3/4	7.0	1,200	7.9	15	6	10,200	25.6	12.8
	AEX0805*S6ETB	2	3/4	7.0	1,200	7.9	15	6	10,200	25.6	12.8
	AEX1225*S6ETB	3	3/4	10.5	1,800	11.4	15	6	15,300	38.4	19.2
	AEX1315*S6ETB	4	3/4	14.0	2,400	14.9	15	6	19,800	49.7	24.9
	AEX1605*S6ETB	4	3/4	14.0	2,400	14.9	15	6	19,800	49.7	24.9
	AEX1765*S6ETB	5	3/4	17.5	3,000	18.4	20	6	34,200	85.9	42.9

Notes:

* = Voltage (see Nomenclature details)

^ = Motor Code Designator (see Nomenclature details)

SPECIFICATIONS

Electric Defrost- 60 Hz

			3 Phase AC Totally Enclosed Rail Mount Motors					Defrost Heaters			
			460/3/60					No. of Heaters	Total Watts	230V/3/60 Hz	460V/3/60 Hz
Model	No. of Fans	HP	Amps	Watts	MCA	MOPD	Total Amps				
3 Fins Per Inch	AEX0325*S3ETB	1	3/4	1.7	600	2.1	15	6	5,700	14.3	7.2
	AEX0505*S3ETB	2	3/4	3.4	1,200	3.8	15	6	10,200	25.6	12.8
	AEX0595*S3ETB	2	3/4	3.4	1,200	3.8	15	6	10,200	25.6	12.8
	AEX0930*S3ETB	3	3/4	5.1	1,800	5.5	15	6	15,300	38.4	19.2
	AEX0975*S3ETB	4	3/4	6.8	2,400	7.2	15	6	19,800	49.7	24.9
	AEX1230*S3ETB	4	3/4	6.8	2,400	7.2	15	6	19,800	49.7	24.9
AEX1620*S3ETB	5	3/4	8.5	3,000	8.9	15	6	34,200	85.9	42.9	
4 Fins Per Inch	AEX0390*S4ETB	1	3/4	1.7	600	2.1	15	6	5,700	14.3	7.2
	AEX0580*S4ETB	2	3/4	3.4	1,200	3.8	15	6	10,200	25.6	12.8
	AEX0675*S4ETB	2	3/4	3.4	1,200	3.8	15	6	10,200	25.6	12.8
	AEX1050*S4ETB	3	3/4	5.1	1,800	5.5	15	6	15,300	38.4	19.2
	AEX1110*S4ETB	4	3/4	6.8	2,400	7.2	15	6	19,800	49.7	24.9
	AEX1385*S4ETB	4	3/4	6.8	2,400	7.2	15	6	19,800	49.7	24.9
AEX1460*S4ETB	5	3/4	8.5	3,000	8.9	15	6	34,200	85.9	42.9	
6 Fins Per Inch	AEX0475*S6ETB	1	3/4	1.7	600	2.1	15	6	5,700	14.3	7.2
	AEX0700*S6ETB	2	3/4	3.4	1,200	3.8	15	6	10,200	25.6	12.8
	AEX0805*S6ETB	2	3/4	3.4	1,200	3.8	15	6	10,200	25.6	12.8
	AEX1225*S6ETB	3	3/4	5.1	1,800	5.5	15	6	15,300	38.4	19.2
	AEX1315*S6ETB	4	3/4	6.8	2,400	7.2	15	6	19,800	49.7	24.9
	AEX1605*S6ETB	4	3/4	6.8	2,400	7.2	15	6	19,800	49.7	24.9
AEX1765*S6ETB	5	3/4	8.5	3,000	8.9	15	6	34,200	85.9	42.9	

Notes:

* = Voltage (see Nomenclature details)

^ = Motor Code Designator (see Nomenclature details)

SPECIFICATIONS

Electric Defrost- 60 Hz

	Model	No. of Fans	HP	3 Phase AC Open Drip Proof Rail Mount Motors				Defrost Heaters			
				Amps	Watts	MCA	MOPD	No. of Heaters	Total Watts	230V/3/60 Hz	460V/3/60 Hz
										Total Amps	
3 Fins Per Inch	AEX0325*S3EYB	1	3/4	3.0	600	3.8	15	6	5,700	14.3	7.2
	AEX0505*S3EYB	2	3/4	6.0	1,200	6.8	15	6	10,200	25.6	12.8
	AEX0595*S3EYB	2	3/4	6.0	1,200	6.8	15	6	10,200	25.6	12.8
	AEX0930*S3EYB	3	3/4	9.0	1,800	9.8	15	6	15,300	38.4	19.2
	AEX0975*S3EYB	4	3/4	12.0	2,400	12.8	15	6	19,800	49.7	24.9
	AEX1230*S3EYB	4	3/4	12.0	2,400	12.8	15	6	19,800	49.7	24.9
	AEX1620*S3EYB	5	3/4	15.0	3,000	15.8	20	6	34,200	85.9	42.9
4 Fins Per Inch	AEX0390*S4EYB	1	3/4	3.0	600	3.8	15	6	5,700	14.3	7.2
	AEX0580*S4EYB	2	3/4	6.0	1,200	6.8	15	6	10,200	25.6	12.8
	AEX0675*S4EYB	2	3/4	6.0	1,200	6.8	15	6	10,200	25.6	12.8
	AEX1050*S4EYB	3	3/4	9.0	1,800	9.8	15	6	15,300	38.4	19.2
	AEX1110*S4EYB	4	3/4	12.0	2,400	12.8	15	6	19,800	49.7	24.9
	AEX1385*S4EYB	4	3/4	12.0	2,400	12.8	15	6	19,800	49.7	24.9
	AEX1460*S4EYB	5	3/4	15.0	3,000	15.8	20	6	34,200	85.9	42.9
6 Fins Per Inch	AEX0475*S6EYB	1	3/4	3.0	600	3.8	15	6	5,700	14.3	7.2
	AEX0700*S6EYB	2	3/4	6.0	1,200	6.8	15	6	10,200	25.6	12.8
	AEX0805*S6EYB	2	3/4	6.0	1,200	6.8	15	6	10,200	25.6	12.8
	AEX1225*S6EYB	3	3/4	9.0	1,800	9.8	15	6	15,300	38.4	19.2
	AEX1315*S6EYB	4	3/4	12.0	2,400	12.8	15	6	19,800	49.7	24.9
	AEX1605*S6EYB	4	3/4	12.0	2,400	12.8	15	6	19,800	49.7	24.9
	AEX1765*S6EYB	5	3/4	15.0	3,000	15.8	20	6	34,200	85.9	42.9

Notes:

* = Voltage (see Nomenclature details)

^ = Motor Code Designator (see Nomenclature details)

SPECIFICATIONS

Electric Defrost- 60 Hz

			3 Phase AC Open Drip Proof Rail Mount Motors					Defrost Heaters			
			460/3/60					No. of Heaters	Total Watts	230V/3/60 Hz	460V/3/60 Hz
Model	No. of Fans	HP	Amps	Watts	MCA	MOPD	Total Amps				
3 Fins Per Inch	AEX0325*S3EYB	1	3/4	1.5	600	1.9	15	6	5,700	14.3	7.2
	AEX0505*S3EYB	2	3/4	3.0	1,200	3.4	15	6	10,200	25.6	12.8
	AEX0595*S3EYB	2	3/4	3.0	1,200	3.4	15	6	10,200	25.6	12.8
	AEX0930*S3EYB	3	3/4	4.5	1,800	4.9	15	6	15,300	38.4	19.2
	AEX0975*S3EYB	4	3/4	6.0	2,400	6.4	15	6	19,800	49.7	24.9
	AEX1230*S3EYB	4	3/4	6.0	2,400	6.4	15	6	19,800	49.7	24.9
4 Fins Per Inch	AEX1620*S3EYB	5	3/4	7.5	3,000	7.9	15	6	34,200	85.9	42.9
	AEX0390*S4EYB	1	3/4	1.5	600	1.9	15	6	5,700	14.3	7.2
	AEX0580*S4EYB	2	3/4	3.0	1,200	3.4	15	6	10,200	25.6	12.8
	AEX0675*S4EYB	2	3/4	3.0	1,200	3.4	15	6	10,200	25.6	12.8
	AEX1050*S4EYB	3	3/4	4.5	1,800	4.9	15	6	15,300	38.4	19.2
	AEX1110*S4EYB	4	3/4	6.0	2,400	6.4	15	6	19,800	49.7	24.9
	AEX1385*S4EYB	4	3/4	6.0	2,400	6.4	15	6	19,800	49.7	24.9
6 Fins Per Inch	AEX1460*S4EYB	5	3/4	7.5	3,000	7.9	15	6	34,200	85.9	42.9
	AEX0475*S6EYB	1	3/4	1.5	600	1.9	15	6	5,700	14.3	7.2
	AEX0700*S6EYB	2	3/4	3.0	1,200	3.4	15	6	10,200	25.6	12.8
	AEX0805*S6EYB	2	3/4	3.0	1,200	3.4	15	6	10,200	25.6	12.8
	AEX1225*S6EYB	3	3/4	4.5	1,800	4.9	15	6	15,300	38.4	19.2
	AEX1315*S6EYB	4	3/4	6.0	2,400	6.4	15	6	19,800	49.7	24.9
	AEX1605*S6EYB	4	3/4	6.0	2,400	6.4	15	6	19,800	49.7	24.9
AEX1765*S6EYB	5	3/4	7.5	3,000	7.9	15	6	34,200	85.9	42.9	

Notes:

* = Voltage (see Nomenclature details)

^ = Motor Code Designator (see Nomenclature details)

SPECIFICATIONS

Electric Defrost- 60 Hz

			3 Phase AC Washdown Rail Mount Motors				Defrost Heaters				
			208-230/3/60				No. of Heaters	Total Watts	230V/3/60 Hz	460V/3/60 Hz	
Model	No. of Fans	HP	Amps	Watts	MCA	MOPD			Total Amps		
3 Fins Per Inch	AEX0325*S3EWB	1	3/4	3.2	600	4.0	15	6	5,700	14.3	7.2
	AEX0505*S3EWB	2	3/4	6.4	1,200	7.2	15	6	10,200	25.6	12.8
	AEX0595*S3EWB	2	3/4	6.4	1,200	7.2	15	6	10,200	25.6	12.8
	AEX0930*S3EWB	3	3/4	9.6	1,800	10.4	15	6	15,300	38.4	19.2
	AEX0975*S3EWB	4	3/4	12.8	2,400	13.6	15	6	19,800	49.7	24.9
	AEX1230*S3EWB	4	3/4	12.8	2,400	13.6	15	6	19,800	49.7	24.9
AEX1620*S3EWB	5	3/4	16.0	3,000	16.8	20	6	34,200	85.9	42.9	
4 Fins Per Inch	AEX0390*S4EWB	1	3/4	3.2	600	4.0	15	6	5,700	14.3	7.2
	AEX0580*S4EWB	2	3/4	6.4	1,200	7.2	15	6	10,200	25.6	12.8
	AEX0675*S4EWB	2	3/4	6.4	1,200	7.2	15	6	10,200	25.6	12.8
	AEX1050*S4EWB	3	3/4	9.6	1,800	10.4	15	6	15,300	38.4	19.2
	AEX1110*S4EWB	4	3/4	12.8	2,400	13.6	15	6	19,800	49.7	24.9
	AEX1385*S4EWB	4	3/4	12.8	2,400	13.6	15	6	19,800	49.7	24.9
AEX1460*S4EWB	5	3/4	16.0	3,000	16.8	20	6	34,200	85.9	42.9	
6 Fins Per Inch	AEX0475*S6EWB	1	3/4	3.2	600	4.0	15	6	5,700	14.3	7.2
	AEX0700*S6EWB	2	3/4	6.4	1,200	7.2	15	6	10,200	25.6	12.8
	AEX0805*S6EWB	2	3/4	6.4	1,200	7.2	15	6	10,200	25.6	12.8
	AEX1225*S6EWB	3	3/4	9.6	1,800	10.4	15	6	15,300	38.4	19.2
	AEX1315*S6EWB	4	3/4	12.8	2,400	13.6	15	6	19,800	49.7	24.9
	AEX1605*S6EWB	4	3/4	12.8	2,400	13.6	15	6	19,800	49.7	24.9
AEX1765*S6EWB	5	3/4	16.0	3,000	16.8	20	6	34,200	85.9	42.9	

Notes:

* = Voltage (see Nomenclature details)

^ = Motor Code Designator (see Nomenclature details)

SPECIFICATIONS

Electric Defrost- 60 Hz

			3 Phase AC Washdown Rail Mount Motors				Defrost Heaters				
			460/3/60				No. of Heaters	Total Watts	230V/3/60 Hz	460V/3/60 Hz	
Model	No. of Fans	HP	Amps	Watts	MCA	MOPD			Total Amps		
3 Fins Per Inch	AEX0325*S3EWB	1	3/4	1.6	600	2.0	15	6	5,700	14.3	7.2
	AEX0505*S3EWB	2	3/4	3.2	1,200	3.6	15	6	10,200	25.6	12.8
	AEX0595*S3EWB	2	3/4	3.2	1,200	3.6	15	6	10,200	25.6	12.8
	AEX0930*S3EWB	3	3/4	4.8	1,800	5.2	15	6	15,300	38.4	19.2
	AEX0975*S3EWB	4	3/4	6.4	2,400	6.8	15	6	19,800	49.7	24.9
	AEX1230*S3EWB	4	3/4	6.4	2,400	6.8	15	6	19,800	49.7	24.9
AEX1620*S3EWB	5	3/4	8.0	3,000	8.4	15	6	34,200	85.9	42.9	
4 Fins Per Inch	AEX0390*S4EWB	1	3/4	1.6	600	2.0	15	6	5,700	14.3	7.2
	AEX0580*S4EWB	2	3/4	3.2	1,200	3.6	15	6	10,200	25.6	12.8
	AEX0675*S4EWB	2	3/4	3.2	1,200	3.6	15	6	10,200	25.6	12.8
	AEX1050*S4EWB	3	3/4	4.8	1,800	5.2	15	6	15,300	38.4	19.2
	AEX1110*S4EWB	4	3/4	6.4	2,400	6.8	15	6	19,800	49.7	24.9
	AEX1385*S4EWB	4	3/4	6.4	2,400	6.8	15	6	19,800	49.7	24.9
AEX1460*S4EWB	5	3/4	8.0	3,000	8.4	15	6	34,200	85.9	42.9	
6 Fins Per Inch	AEX0475*S6EWB	1	3/4	1.6	600	2.0	15	6	5,700	14.3	7.2
	AEX0700*S6EWB	2	3/4	3.2	1,200	3.6	15	6	10,200	25.6	12.8
	AEX0805*S6EWB	2	3/4	3.2	1,200	3.6	15	6	10,200	25.6	12.8
	AEX1225*S6EWB	3	3/4	4.8	1,800	5.2	15	6	15,300	38.4	19.2
	AEX1315*S6EWB	4	3/4	6.4	2,400	6.8	15	6	19,800	49.7	24.9
	AEX1605*S6EWB	4	3/4	6.4	2,400	6.8	15	6	19,800	49.7	24.9
AEX1765*S6EWB	5	3/4	8.0	3,000	8.4	15	6	34,200	85.9	42.9	

Notes:

* = Voltage (see Nomenclature details)

SPECIFICATIONS

Electric Defrost- 50 Hz

			380-400/3/50				Defrost Heaters			
			3 Phase AC Totally Enclosed Rail Mount Motors				No. of Heaters	Total Watts	380V/3/50 Hz	
Model	No. of Fans	HP	Amps	Watts	MCA	MOPD			Total Amps	
3 Fins Per Inch	AEX0325XS3E^B	1	3/4	1.7	600	2.1	15	6	5,700	8.7
	AEX0505XS3E^B	2	3/4	3.4	1,200	3.8	15	6	10,200	15.5
	AEX0595XS3E^B	2	3/4	3.4	1,200	3.8	15	6	10,200	15.5
	AEX0930XS3E^B	3	3/4	5.1	1,800	5.5	15	6	15,300	23.3
	AEX0975XS3E^B	4	3/4	6.8	2,400	7.2	15	6	19,800	30.1
	AEX1230XS3E^B	4	3/4	6.8	2,400	7.2	15	6	19,800	30.1
	AEX1620XS3E^B	5	3/4	8.5	3,000	8.9	15	6	34,200	52.0
4 Fins Per Inch	AEX0390XS4E^B	1	3/4	1.7	600	2.1	15	6	5,700	8.7
	AEX0580XS4E^B	2	3/4	3.4	1,200	3.8	15	6	10,200	15.5
	AEX0675XS4E^B	2	3/4	3.4	1,200	3.8	15	6	10,200	15.5
	AEX1050XS4E^B	3	3/4	5.1	1,800	5.5	15	6	15,300	23.3
	AEX1110XS4E^B	4	3/4	6.8	2,400	7.2	15	6	19,800	30.1
	AEX1385XS4E^B	4	3/4	6.8	2,400	7.2	15	6	19,800	30.1
	AEX1460XS4E^B	5	3/4	8.5	3,000	8.9	15	6	34,200	52.0
6 Fins Per Inch	AEX0475XS6E^B	1	3/4	1.7	600	2.1	15	6	5,700	8.7
	AEX0700XS6E^B	2	3/4	3.4	1,200	3.8	15	6	10,200	15.5
	AEX0805XS6E^B	2	3/4	3.4	1,200	3.8	15	6	10,200	15.5
	AEX1225XS6E^B	3	3/4	5.1	1,800	5.5	15	6	15,300	23.3
	AEX1315XS6E^B	4	3/4	6.8	2,400	7.2	15	6	19,800	30.1
	AEX1605XS6E^B	4	3/4	6.8	2,400	7.2	15	6	19,800	30.1
	AEX1765XS6E^B	5	3/4	8.5	3,000	8.9	15	6	34,200	52.0

Notes:

^ = Motor Code Designator (see Nomenclature details)

SPECIFICATIONS

Electric Defrost- 50 Hz

			380-400/3/50				Defrost Heaters			
			3 Phase AC Open Drip Proof Rail Mount Motors				No. of Heaters	Total Watts	380V/3/50 Hz	
Model	No. of Fans	HP	Amps	Watts	MCA	MOPD			Total Amps	
3 Fins Per Inch	AEX0325XS3E^B	1	3/4	1.5	600	1.9	15	6	5,700	8.7
	AEX0505XS3E^B	2	3/4	3.0	1,200	3.4	15	6	10,200	15.5
	AEX0595XS3E^B	2	3/4	3.0	1,200	3.4	15	6	10,200	15.5
	AEX0930XS3E^B	3	3/4	4.5	1,800	4.9	15	6	15,300	23.3
	AEX0975XS3E^B	4	3/4	6.0	2,400	6.4	15	6	19,800	30.1
	AEX1230XS3E^B	4	3/4	6.0	2,400	6.4	15	6	19,800	30.1
	AEX1620XS3E^B	5	3/4	7.5	3,000	7.9	15	6	34,200	52.0
4 Fins Per Inch	AEX0390XS4E^B	1	3/4	1.5	600	1.9	15	6	5,700	8.7
	AEX0580XS4E^B	2	3/4	3.0	1,200	3.4	15	6	10,200	15.5
	AEX0675XS4E^B	2	3/4	3.0	1,200	3.4	15	6	10,200	15.5
	AEX1050XS4E^B	3	3/4	4.5	1,800	4.9	15	6	15,300	23.3
	AEX1110XS4E^B	4	3/4	6.0	2,400	6.4	15	6	19,800	30.1
	AEX1385XS4E^B	4	3/4	6.0	2,400	6.4	15	6	19,800	30.1
	AEX1460XS4E^B	5	3/4	7.5	3,000	7.9	15	6	34,200	52.0
6 Fins Per Inch	AEX0475XS6E^B	1	3/4	1.5	600	1.9	15	6	5,700	8.7
	AEX0700XS6E^B	2	3/4	3.0	1,200	3.4	15	6	10,200	15.5
	AEX0805XS6E^B	2	3/4	3.0	1,200	3.4	15	6	10,200	15.5
	AEX1225XS6E^B	3	3/4	4.5	1,800	4.9	15	6	15,300	23.3
	AEX1315XS6E^B	4	3/4	6.0	2,400	6.4	15	6	19,800	30.1
	AEX1605XS6E^B	4	3/4	6.0	2,400	6.4	15	6	19,800	30.1
	AEX1765XS6E^B	5	3/4	7.5	3,000	7.9	15	6	34,200	52.0

Notes:

^ = Motor Code Designator (see Nomenclature details)

SPECIFICATIONS

Electric Defrost- 50 Hz

			380-400/3/50				Defrost Heaters			
			3 Phase AC Washdown Rail Mount Motors				No. of Heaters	Total Watts	380V/3/50 Hz	
Model	No. of Fans	HP	Amps	Watts	MCA	MOPD			Total Amps	
3 Fins Per Inch	AEX0325XS3E^B	1	3/4	1.6	600	2.0	15	6	5,700	8.7
	AEX0505XS3E^B	2	3/4	3.2	1,200	3.6	15	6	10,200	15.5
	AEX0595XS3E^B	2	3/4	3.2	1,200	3.6	15	6	10,200	15.5
	AEX0930XS3E^B	3	3/4	4.8	1,800	5.2	15	6	15,300	23.3
	AEX0975XS3E^B	4	3/4	6.4	2,400	6.8	15	6	19,800	30.1
	AEX1230XS3E^B	4	3/4	6.4	2,400	6.8	15	6	19,800	30.1
	AEX1620XS3E^B	5	3/4	8.0	3,000	8.4	15	6	34,200	52.0
4 Fins Per Inch	AEX0390XS4E^B	1	3/4	1.6	600	2.0	15	6	5,700	8.7
	AEX0580XS4E^B	2	3/4	3.2	1,200	3.6	15	6	10,200	15.5
	AEX0675XS4E^B	2	3/4	3.2	1,200	3.6	15	6	10,200	15.5
	AEX1050XS4E^B	3	3/4	4.8	1,800	5.2	15	6	15,300	23.3
	AEX1110XS4E^B	4	3/4	6.4	2,400	6.8	15	6	19,800	30.1
	AEX1385XS4E^B	4	3/4	6.4	2,400	6.8	15	6	19,800	30.1
	AEX1460XS4E^B	5	3/4	8.0	3,000	8.4	15	6	34,200	52.0
6 Fins Per Inch	AEX0475XS6E^B	1	3/4	1.6	600	2.0	15	6	5,700	8.7
	AEX0700XS6E^B	2	3/4	3.2	1,200	3.6	15	6	10,200	15.5
	AEX0805XS6E^B	2	3/4	3.2	1,200	3.6	15	6	10,200	15.5
	AEX1225XS6E^B	3	3/4	4.8	1,800	5.2	15	6	15,300	23.3
	AEX1315XS6E^B	4	3/4	6.4	2,400	6.8	15	6	19,800	30.1
	AEX1605XS6E^B	4	3/4	6.4	2,400	6.8	15	6	19,800	30.1
	AEX1765XS6E^B	5	3/4	8.0	3,000	8.4	15	6	34,200	52.0

Notes:

^ = Motor Code Designator (see Nomenclature details)

SPECIFICATIONS

Electric Defrost- 50 Hz

			380-400/3/50				Defrost Heaters			
			Fixed Speed EC External Rotor & Variable Speed EC External Rotor Motors				No. of Heaters	Total Watts	380V/3/50 Hz	
Model	No. of Fans	HP	Amps	Watts	MCA	MOPD			Total Amps	
3 Fins Per Inch	AEX0325XS3E^B	1	1	1.5	960	1.9	15	6	5,700	8.7
	AEX0505XS3E^B	2	1	3.0	1,920	3.4	15	6	10,200	15.5
	AEX0595XS3E^B	2	1	3.0	1,920	3.4	15	6	10,200	15.5
	AEX0930XS3E^B	3	1	4.5	2,880	4.9	15	6	15,300	23.3
	AEX0975XS3E^B	4	1	6.0	3,840	6.4	15	6	19,800	30.1
	AEX1230XS3E^B	4	1	6.0	3,840	6.4	15	6	19,800	30.1
	AEX1620XS3E^B	5	1	7.5	4,800	7.9	15	6	34,200	52.0
4 Fins Per Inch	AEX0390XS4E^B	1	1	1.5	960	1.9	15	6	5,700	8.7
	AEX0580XS4E^B	2	1	3.0	1,920	3.4	15	6	10,200	15.5
	AEX0675XS4E^B	2	1	3.0	1,920	3.4	15	6	10,200	15.5
	AEX1050XS4E^B	3	1	4.5	2,880	4.9	15	6	15,300	23.3
	AEX1110XS4E^B	4	1	6.0	3,840	6.4	15	6	19,800	30.1
	AEX1385XS4E^B	4	1	6.0	3,840	6.4	15	6	19,800	30.1
	AEX1460XS4E^B	5	1	7.5	4,800	7.9	15	6	34,200	52.0
6 Fins Per Inch	AEX0475XS6E^B	1	1	1.5	960	1.9	15	6	5,700	8.7
	AEX0700XS6E^B	2	1	3.0	1,920	3.4	15	6	10,200	15.5
	AEX0805XS6E^B	2	1	3.0	1,920	3.4	15	6	10,200	15.5
	AEX1225XS6E^B	3	1	4.5	2,880	4.9	15	6	15,300	23.3
	AEX1315XS6E^B	4	1	6.0	3,840	6.4	15	6	19,800	30.1
	AEX1605XS6E^B	4	1	6.0	3,840	6.4	15	6	19,800	30.1
	AEX1765XS6E^B	5	1	7.5	4,800	7.9	15	6	34,200	52.0

Notes:

^ = Motor Code Designator (see Nomenclature details)

PERFORMANCE DATA

Magna Simulation Capacity: Hot Gas Defrost- 60 Hz

		Magna Simulation Capacity				Fan Data			Air Throw Per Side
		R-404A/R-507A		R-448A/R-449A					
		Model	10°F TD/25°F SST 80% RH BTUH	6°C TD/-4°C SST 80% RH Watts	10°F TD/25°F SST 80% RH BTUH	6°C TD/-4°C SST 80% RH Watts	No. of Fans	CFM	m³H
3 Fins Per Inch	AEX0325*S3H^B	17,679	5,181	24,552	7,195	1	3,750	6,371	25
	AEX0505*S3H^B	30,793	9,025	40,774	11,950	2	7,500	12,743	25
	AEX0595*S3H^B	38,598	11,312	51,631	15,132	2	7,500	12,743	25
	AEX0930*S3H^B	54,940	16,101	78,014	22,864	3	11,250	19,114	25
	AEX0975*S3H^B	60,428	17,710	82,558	24,195	4	15,000	25,485	25
	AEX1230*S3H^B	74,497	21,833	103,425	30,311	4	15,000	25,485	25
	AEX1620*S3H^B	98,106	28,752	127,796	37,453	5	18,750	31,856	25
4 Fins Per Inch	AEX0390*S4H^B	20,711	6,070	29,313	8,591	1	3,750	6,371	25
	AEX0580*S4H^B	34,292	10,050	46,401	13,599	2	7,500	12,743	25
	AEX0675*S4H^B	41,116	12,050	58,900	17,262	2	7,500	12,743	25
	AEX1050*S4H^B	61,316	17,970	88,805	26,026	3	11,250	19,114	25
	AEX1110*S4H^B	66,400	19,460	94,738	27,765	4	15,000	24,485	25
	AEX1385*S4H^B	81,277	23,820	117,766	34,514	4	15,000	25,485	25
	AEX1460*S4H^B	84,928	24,890	118,239	34,652	5	18,750	31,856	25
6 Fins Per Inch	AEX0475*S6H^B	24,465	7,170	33,629	9,856	1	3,750	6,371	25
	AEX0700*S6H^B	40,877	11,980	56,856	16,663	2	7,500	12,743	25
	AEX0805*S6H^B	47,258	13,850	69,307	20,312	2	7,500	12,743	25
	AEX1225*S6H^B	70,324	20,610	103,930	30,459	3	11,250	19,114	25
	AEX1315*S6H^B	82,232	24,100	113,189	33,172	4	15,000	25,485	25
	AEX1605*S6H^B	93,117	27,290	137,852	40,400	4	15,000	25,485	25
	AEX1765*S6H^B	100,009	29,310	142,025	41,623	5	18,750	31,856	25

Notes:

* = Voltage (see Nomenclature details)

^ = Motor Code Designator (see Nomenclature details)

PERFORMANCE DATA

Magna Simulation Capacity: Hot Gas Defrost- 60 Hz

		Magna Simulation Capacity				Fan Data			Air Throw Per Side
		R-407A/R-407F		R-407C					
		Model	10°F TD/25°F SST 80% RH BTUH	6°C TD/-4°C SST 80% RH Watts	10°F TD/25°F SST 80% RH BTUH	6°C TD/-4°C SST 80% RH Watts	No. of Fans	CFM	m³H
3 Fins Per Inch	AEX0325*S3H^B	22,099	6,477	23,905	7,006	1	3,750	6,371	25
	AEX0505*S3H^B	38,491	112,281	40,438	11,851	2	7,500	12,743	25
	AEX0595*S3H^B	48,248	14,140	51,557	15,110	2	7,500	12,743	25
	AEX0930*S3H^B	68,675	20,127	77,247	22,639	3	11,250	19,114	25
	AEX0975*S3H^B	75,535	22,137	82,049	24,046	4	15,000	25,485	25
	AEX1230*S3H^B	93,121	27,291	102,825	30,135	4	15,000	25,485	25
	AEX1620*S3H^B	122,633	35,940	126,758	37,149	5	18,750	31,856	25
4 Fins Per Inch	AEX0390*S4H^B	25,889	7,587	30,026	8,800	1	3,750	6,371	25
	AEX0580*S4H^B	42,865	12,562	49,134	14,400	2	7,500	12,743	25
	AEX0675*S4H^B	51,395	15,062	59,200	17,350	2	7,500	12,743	25
	AEX1050*S4H^B	76,645	22,462	87,828	25,740	3	11,250	19,114	25
	AEX1110*S4H^B	83,000	24,325	93,526	27,410	4	15,000	25,485	25
	AEX1385*S4H^B	101,596	29,775	116,524	34,150	4	15,000	25,485	25
	AEX1460*S4H^B	106,160	31,112	120,550	35,330	5	18,750	31,856	25
6 Fins Per Inch	AEX0475*S6H^B	30,581	8,962	36,305	10,640	1	3,750	6,371	25
	AEX0700*S6H^B	51,096	14,975	58,893	17,260	2	7,500	12,743	25
	AEX0805*S6H^B	59,073	17,312	68,652	20,120	2	7,500	12,743	25
	AEX1225*S6H^B	87,905	25,762	101,408	29,720	3	11,250	19,114	25
	AEX1315*S6H^B	102,790	30,125	118,640	34,770	4	15,000	25,485	25
	AEX1605*S6H^B	116,396	34,112	133,585	39,150	4	15,000	25,485	25
	AEX1765*S6H^B	125,011	36,637	142,525	41,770	5	18,750	31,856	25

Notes:

* = Voltage (see Nomenclature details)

^ = Motor Code Designator (see Nomenclature details)

PERFORMANCE DATA

Magna Simulation Capacity: Hot Gas Defrost- 50 Hz

		Magna Simulation Capacity				Fan Data			Air Throw Per Side
		R-404A/R-507A		R-448A/R-449A					
		Model	10°F TD/25°F SST 80% RH BTUH	6°C TD/-4°C SST 80% RH Watts	10°F TD/25°F SST 80% RH BTUH	6°C TD/-4°C SST 80% RH Watts	No. of Fans	CFM	m³H
3 Fins Per Inch	AEX0325*S3H^B	17,679	5,181	24,552	7,195	1	3,050	5,182	25
	AEX0505*S3H^B	30,793	9,025	40,774	11,950	2	6,100	10,364	25
	AEX0595*S3H^B	38,598	11,312	51,631	15,132	2	6,100	10,364	25
	AEX0930*S3H^B	54,940	16,101	78,014	22,864	3	9,150	15,546	25
	AEX0975*S3H^B	60,428	17,710	82,558	24,195	4	12,200	20,728	25
	AEX1230*S3H^B	74,497	21,833	103,425	30,311	4	12,200	22,728	25
	AEX1620*S3H^B	98,106	28,752	127,796	37,453	5	15,250	25,910	25
4 Fins Per Inch	AEX0390*S4H^B	20,711	6,070	29,313	8,591	1	3,050	5,182	25
	AEX0580*S4H^B	34,292	10,050	46,401	13,599	2	6,100	10,364	25
	AEX0675*S4H^B	41,116	12,050	58,900	17,262	2	6,100	10,364	25
	AEX1050*S4H^B	61,316	17,970	88,805	26,026	3	9,150	15,546	25
	AEX1110*S4H^B	66,400	19,460	94,738	27,765	4	12,200	20,728	25
	AEX1385*S4H^B	81,277	23,820	117,766	34,514	4	12,200	20,728	25
	AEX1460*S4H^B	84,928	24,890	118,239	34,652	5	15,250	25,910	25
6 Fins Per Inch	AEX0475*S6H^B	24,465	7,170	33,629	9,856	1	3,050	5,182	25
	AEX0700*S6H^B	40,877	11,980	56,856	16,663	2	6,100	10,364	25
	AEX0805*S6H^B	47,258	13,850	69,307	20,312	2	6,100	10,364	25
	AEX1225*S6H^B	70,324	20,610	103,930	30,459	3	9,150	15,546	25
	AEX1315*S6H^B	82,232	24,100	113,189	33,172	4	12,200	20,728	25
	AEX1605*S6H^B	93,117	27,290	137,852	40,400	4	12,200	20,728	25
	AEX1765*S6H^B	100,009	29,310	142,025	41,623	5	15,250	25,910	25

Notes:

* = Voltage (see Nomenclature details)

^ = Motor Code Designator (see Nomenclature details)

PERFORMANCE DATA

Magna Simulation Capacity: Hot Gas Defrost- 50 Hz

		Magna Simulation Capacity				Fan Data			Air Throw Per Side
		R-407A/R-407F		R-407C					
		Model	10°F TD/25°F SST 80% RH BTUH	6°C TD/-4°C SST 80% RH Watts	10°F TD/25°F SST 80% RH BTUH	6°C TD/-4°C SST 80% RH Watts	No. of Fans	CFM	m³H
3 Fins Per Inch	AEX0325*S3H^B	22,099	6,477	23,905	7,006	1	3,050	5,182	25
	AEX0505*S3H^B	38,491	11,281	40,438	11,851	2	6,100	10,364	25
	AEX0595*S3H^B	48,248	14,140	51,557	15,110	2	6,100	10,364	25
	AEX0930*S3H^B	68,675	20,127	77,247	22,639	3	9,150	15,546	25
	AEX0975*S3H^B	75,535	22,137	82,049	24,046	4	12,200	20,728	25
	AEX1230*S3H^B	93,121	27,291	102,825	30,135	4	12,200	20,728	25
	AEX1620*S3H^B	122,633	35,940	126,758	37,149	5	15,250	25,910	25
4 Fins Per Inch	AEX0390*S4H^B	25,899	7,587	30,026	8,800	1	3,050	5,182	25
	AEX0580*S4H^B	42,865	12,562	49,134	14,400	2	6,100	10,364	25
	AEX0675*S4H^B	51,395	15,062	59,200	17,350	2	6,100	10,364	25
	AEX1050*S4H^B	76,645	22,462	87,828	25,740	3	9,150	15,546	25
	AEX1110*S4H^B	83,000	24,325	93,526	27,410	4	12,200	20,728	25
	AEX1385*S4H^B	101,596	29,775	116,524	34,150	4	12,200	20,728	25
	AEX1460*S4H^B	106,160	31,112	120,550	35,330	5	15,250	25,910	25
6 Fins Per Inch	AEX0475*S6H^B	30,581	8,962	36,305	10,640	1	3,050	5,182	25
	AEX0700*S6H^B	51,096	14,975	58,893	17,260	2	6,100	10,364	25
	AEX0805*S6H^B	59,073	17,312	68,652	20,120	2	6,100	10,364	25
	AEX1225*S6H^B	87,905	25,762	101,408	29,720	3	9,150	15,546	25
	AEX1315*S6H^B	102,790	30,125	118,640	34,770	4	12,200	20,728	25
	AEX1605*S6H^B	116,396	34,112	133,585	39,150	4	12,200	20,728	25
	AEX1765*S6H^B	125,011	36,637	142,525	41,770	5	15,250	25,910	25

Notes:

* = Voltage (see Nomenclature details)

^ = Motor Code Designator (see Nomenclature details)

SPECIFICATIONS

Hot Gas Defrost- 60 Hz

			Fixed Speed EC External Rotor & Variable Speed EC External Rotor Motors				Drain Pan Heaters				
			208-230/1/60				No. of Heaters	Total Watts	230V/3/60 Hz	460V/3/60 Hz	
Model	No. of Fans	HP	Amps	Watts	MCA	MOPD			Total Amps		
3 Fins Per Inch	AEX0325*S3H^B	1	1	3.3	740	4.1	15	-	-	-	-
	AEX0505*S3H^B	2	1	6.6	1,480	7.3	15	-	-	-	-
	AEX0595*S3H^B	2	1	6.6	1,480	7.3	15	-	-	-	-
	AEX0930*S3H^B	3	1	9.9	2,220	7.3	15	-	-	-	-
	AEX0975*S3H^B	4	1	13.2	2,960	10.6	15	-	-	-	-
	AEX1230*S3H^B	4	1	13.2	2,960	10.6	15	-	-	-	-
	AEX1620*S3H^B	5	1	16.5	3,700	13.8	15	-	-	-	-
4 Fins Per Inch	AEX0390*S4H^B	1	1	3.3	740	4.1	15	-	-	-	-
	AEX0580*S4H^B	2	1	6.6	1,480	7.3	15	-	-	-	-
	AEX0675*S4H^B	2	1	6.6	1,480	7.3	15	-	-	-	-
	AEX1050*S4H^B	3	1	9.9	2,220	7.3	15	-	-	-	-
	AEX1110*S4H^B	4	1	13.2	2,960	10.6	15	-	-	-	-
	AEX1385*S4H^B	4	1	13.2	2,960	10.6	15	-	-	-	-
	AEX1460*S4H^B	5	1	16.5	3,700	13.8	15	-	-	-	-
6 Fins Per Inch	AEX0475*S6H^B	1	1	3.3	740	4.1	15	-	-	-	-
	AEX0700*S6H^B	2	1	6.6	1,480	7.3	15	-	-	-	-
	AEX0805*S6H^B	2	1	6.6	1,480	7.3	15	-	-	-	-
	AEX1225*S6H^B	3	1	9.9	2,220	7.3	15	-	-	-	-
	AEX1315*S6H^B	4	1	13.2	2,960	10.6	15	-	-	-	-
	AEX1605*S6H^B	4	1	13.2	2,960	10.6	15	-	-	-	-
	AEX1765*S6H^B	5	1	16.5	3,700	13.8	15	-	-	-	-

Notes:

* = Voltage (see Nomenclature details)

^ = Motor Code Designator (see Nomenclature details)

SPECIFICATIONS

Hot Gas Defrost- 60 Hz

			Fixed Speed EC External Rotor & Variable Speed EC External Rotor Motors				Drain Pan Heaters				
			460/3/60				No. of Heaters	Total Watts	230V/3/60 Hz	460V/3/60 Hz	
Model	No. of Fans	HP	Amps	Watts	MCA	MOPD			Total Amps		
3 Fins Per Inch	AEX0325*S3H^B	1	1	1.5	960	1.9	15	-	-	-	-
	AEX0505*S3H^B	2	1	3.0	1,920	3.4	15	-	-	-	-
	AEX0595*S3H^B	2	1	3.0	1,920	3.4	15	-	-	-	-
	AEX0930*S3H^B	3	1	4.5	2,880	4.9	15	-	-	-	-
	AEX0975*S3H^B	4	1	6.0	3,840	6.4	15	-	-	-	-
	AEX1230*S3H^B	4	1	6.0	3,840	6.4	15	-	-	-	-
	AEX1620*S3H^B	5	1	7.5	4,800	7.9	15	-	-	-	-
4 Fins Per Inch	AEX0390*S4H^B	1	1	1.5	960	1.9	15	-	-	-	-
	AEX0580*S4H^B	2	1	3.0	1,920	3.4	15	-	-	-	-
	AEX0675*S4H^B	2	1	3.0	1,920	3.4	15	-	-	-	-
	AEX1050*S4H^B	3	1	4.5	2,880	4.9	15	-	-	-	-
	AEX1110*S4H^B	4	1	6.0	3,840	6.4	15	-	-	-	-
	AEX1385*S4H^B	4	1	6.0	3,840	6.4	15	-	-	-	-
	AEX1460*S4H^B	5	1	7.5	4,800	7.9	15	-	-	-	-
6 Fins Per Inch	AEX0475*S6H^B	1	1	1.5	960	1.9	15	-	-	-	-
	AEX0700*S6H^B	2	1	3.0	1,920	3.4	15	-	-	-	-
	AEX0805*S6H^B	2	1	3.0	1,920	3.4	15	-	-	-	-
	AEX1225*S6H^B	3	1	4.5	2,880	4.9	15	-	-	-	-
	AEX1315*S6H^B	4	1	6.0	3,840	6.4	15	-	-	-	-
	AEX1605*S6H^B	4	1	6.0	3,840	6.4	15	-	-	-	-
	AEX1765*S6H^B	5	1	7.5	4,800	7.9	15	-	-	-	-

Notes:

* = Voltage (see Nomenclature details)

^ = Motor Code Designator (see Nomenclature details)

SPECIFICATIONS

Hot Gas Defrost- 60 Hz

			3 Phase AC Totally Enclosed Rail Mount Motors				Drain Pan Heaters				
			208-230/3/60				No. of Heaters	Total Watts	230V/3/60 Hz	460V/3/60 Hz	
Model	No. of Fans	HP	Amps	Watts	MCA	MOPD			Total Amps		
3 Fins Per Inch	AEX0325*S3HTB	1	3/4	3.5	600	4.4	15	-	-	-	-
	AEX0505*S3HTB	2	3/4	7.0	1,200	7.9	15	-	-	-	-
	AEX0595*S3HTB	2	3/4	7.0	1,200	7.9	15	-	-	-	-
	AEX0930*S3HTB	3	3/4	10.5	1,800	11.4	15	-	-	-	-
	AEX0975*S3HTB	4	3/4	14.0	2,400	14.9	15	-	-	-	-
	AEX1230*S3HTB	4	3/4	14.0	2,400	14.9	15	-	-	-	-
AEX1620*S3HTB	5	3/4	17.5	3,000	18.4	20	-	-	-	-	
4 Fins Per Inch	AEX0390*S4HTB	1	3/4	3.5	600	4.4	15	-	-	-	-
	AEX0580*S4HTB	2	3/4	7.0	1,200	7.9	15	-	-	-	-
	AEX0675*S4HTB	2	3/4	7.0	1,200	7.9	15	-	-	-	-
	AEX1050*S4HTB	3	3/4	10.5	1,800	11.4	15	-	-	-	-
	AEX1110*S4HTB	4	3/4	14.0	2,400	14.9	15	-	-	-	-
	AEX1385*S4HTB	4	3/4	14.0	2,400	14.9	15	-	-	-	-
AEX1460*S4HTB	5	3/4	17.5	3,000	18.4	20	-	-	-	-	
6 Fins Per Inch	AEX0475*S6HTB	1	3/4	3.5	600	4.4	15	-	-	-	-
	AEX0700*S6HTB	2	3/4	7.0	1,200	7.9	15	-	-	-	-
	AEX0805*S6HTB	2	3/4	7.0	1,200	7.9	15	-	-	-	-
	AEX1225*S6HTB	3	3/4	10.5	1,800	11.4	15	-	-	-	-
	AEX1315*S6HTB	4	3/4	14.0	2,400	14.9	15	-	-	-	-
	AEX1605*S6HTB	4	3/4	14.0	2,400	14.9	15	-	-	-	-
AEX1765*S6HTB	5	3/4	17.5	3,000	18.4	20	-	-	-	-	

Notes:

* = Voltage (see Nomenclature details)

^ = Motor Code Designator (see Nomenclature details)

SPECIFICATIONS

Hot Gas Defrost- 60 Hz

			3 Phase AC Totally Enclosed Rail Mount Motors				Drain Pan Heaters				
			460/3/60				No. of Heaters	Total Watts	230V/3/60 Hz	460V/3/60 Hz	
Model	No. of Fans	HP	Amps	Watts	MCA	MOPD			Total Amps		
3 Fins Per Inch	AEX0325*S3HTB	1	3/4	1.7	600	2.1	15	-	-	-	-
	AEX0505*S3HTB	2	3/4	3.4	1,200	3.8	15	-	-	-	-
	AEX0595*S3HTB	2	3/4	3.4	1,200	3.8	15	-	-	-	-
	AEX0930*S3HTB	3	3/4	5.1	1,800	5.5	15	-	-	-	-
	AEX0975*S3HTB	4	3/4	6.8	2,400	7.2	15	-	-	-	-
	AEX1230*S3HTB	4	3/4	6.8	2,400	7.2	15	-	-	-	-
AEX1620*S3HTB	5	3/4	8.5	3,000	8.9	15	-	-	-	-	
4 Fins Per Inch	AEX0390*S4HTB	1	3/4	1.7	600	2.1	15	-	-	-	-
	AEX0580*S4HTB	2	3/4	3.4	1,200	3.8	15	-	-	-	-
	AEX0675*S4HTB	2	3/4	3.4	1,200	3.8	15	-	-	-	-
	AEX1050*S4HTB	3	3/4	5.1	1,800	5.5	15	-	-	-	-
	AEX1110*S4HTB	4	3/4	6.8	2,400	7.2	15	-	-	-	-
	AEX1385*S4HTB	4	3/4	6.8	2,400	7.2	15	-	-	-	-
AEX1460*S4HTB	5	3/4	8.5	3,000	8.9	15	-	-	-	-	
6 Fins Per Inch	AEX0475*S6HTB	1	3/4	1.7	600	2.1	15	-	-	-	-
	AEX0700*S6HTB	2	3/4	3.4	1,200	3.8	15	-	-	-	-
	AEX0805*S6HTB	2	3/4	3.4	1,200	3.8	15	-	-	-	-
	AEX1225*S6HTB	3	3/4	5.1	1,800	5.5	15	-	-	-	-
	AEX1315*S6HTB	4	3/4	6.8	2,400	7.2	15	-	-	-	-
	AEX1605*S6HTB	4	3/4	6.8	2,400	7.2	15	-	-	-	-
AEX1765*S6HTB	5	3/4	8.5	3,000	8.9	15	-	-	-	-	

Notes:

* = Voltage (see Nomenclature details)

^ = Motor Code Designator (see Nomenclature details)

SPECIFICATIONS

Hot Gas Defrost- 60 Hz

			3 Phase AC Open Drip Proof Rail Mount Motors				Drain Pan Heaters				
			208-230/3/60				No. of Heaters	Total Watts	230V/3/60 Hz	460V/3/60 Hz	
Model	No. of Fans	HP	Amps	Watts	MCA	MOPD			Total Amps		
3 Fins Per Inch	AEX0325*S3HYB	1	3/4	3.0	600	3.8	15	-	-	-	-
	AEX0505*S3HYB	2	3/4	6.0	1,200	6.8	15	-	-	-	-
	AEX0595*S3HYB	2	3/4	6.0	1,200	6.8	15	-	-	-	-
	AEX0930*S3HYB	3	3/4	9.0	1,800	9.8	15	-	-	-	-
	AEX0975*S3HYB	4	3/4	12.0	2,400	12.8	15	-	-	-	-
	AEX1230*S3HYB	4	3/4	12.0	2,400	12.8	15	-	-	-	-
	AEX1620*S3HYB	5	3/4	15.0	3,000	15.8	20	-	-	-	-
4 Fins Per Inch	AEX0390*S4HYB	1	3/4	3.0	600	3.8	15	-	-	-	-
	AEX0580*S4HYB	2	3/4	6.0	1,200	6.8	15	-	-	-	-
	AEX0675*S4HYB	2	3/4	6.0	1,200	6.8	15	-	-	-	-
	AEX1050*S4HYB	3	3/4	9.0	1,800	9.8	15	-	-	-	-
	AEX1110*S4HYB	4	3/4	12.0	2,400	12.8	15	-	-	-	-
	AEX1385*S4HYB	4	3/4	12.0	2,400	12.8	15	-	-	-	-
	AEX1460*S4HYB	5	3/4	15.0	3,000	15.8	20	-	-	-	-
6 Fins Per Inch	AEX0475*S6HYB	1	3/4	3.0	600	3.8	15	-	-	-	-
	AEX0700*S6HYB	2	3/4	6.0	1,200	6.8	15	-	-	-	-
	AEX0805*S6HYB	2	3/4	6.0	1,200	6.8	15	-	-	-	-
	AEX1225*S6HYB	3	3/4	9.0	1,800	9.8	15	-	-	-	-
	AEX1315*S6HYB	4	3/4	12.0	2,400	12.8	15	-	-	-	-
	AEX1605*S6HYB	4	3/4	12.0	2,400	12.8	15	-	-	-	-
	AEX1765*S6HYB	5	3/4	15.0	3,000	15.8	20	-	-	-	-

Notes:

* = Voltage (see Nomenclature details)

^ = Motor Code Designator (see Nomenclature details)

SPECIFICATIONS

Hot Gas Defrost- 60 Hz

			3 Phase AC Open Drip Proof Rail Mount Motors				Drain Pan Heaters				
			460/3/60				No. of Heaters	Total Watts	230V/3/60 Hz	460V/3/60 Hz	
Model	No. of Fans	HP	Amps	Watts	MCA	MOPD			Total Amps		
3 Fins Per Inch	AEX0325*S3HYB	1	3/4	1.5	600	1.9	15	-	-	-	-
	AEX0505*S3HYB	2	3/4	3.0	1,200	3.4	15	-	-	-	-
	AEX0595*S3HYB	2	3/4	3.0	1,200	3.4	15	-	-	-	-
	AEX0930*S3HYB	3	3/4	4.5	1,800	4.9	15	-	-	-	-
	AEX0975*S3HYB	4	3/4	6.0	2,400	6.4	15	-	-	-	-
	AEX1230*S3HYB	4	3/4	6.0	2,400	6.4	15	-	-	-	-
AEX1620*S3HYB	5	3/4	7.5	3,000	7.9	15	-	-	-	-	
4 Fins Per Inch	AEX0390*S4HYB	1	3/4	1.5	600	1.9	15	-	-	-	-
	AEX0580*S4HYB	2	3/4	3.0	1,200	3.4	15	-	-	-	-
	AEX0675*S4HYB	2	3/4	3.0	1,200	3.4	15	-	-	-	-
	AEX1050*S4HYB	3	3/4	4.5	1,800	4.9	15	-	-	-	-
	AEX1110*S4HYB	4	3/4	6.0	2,400	6.4	15	-	-	-	-
	AEX1385*S4HYB	4	3/4	6.0	2,400	6.4	15	-	-	-	-
AEX1460*S4HYB	5	3/4	7.5	3,000	7.9	15	-	-	-	-	
6 Fins Per Inch	AEX0475*S6HYB	1	3/4	1.5	600	1.9	15	-	-	-	-
	AEX0700*S6HYB	2	3/4	3.0	1,200	3.4	15	-	-	-	-
	AEX0805*S6HYB	2	3/4	3.0	1,200	3.4	15	-	-	-	-
	AEX1225*S6HYB	3	3/4	4.5	1,800	4.9	15	-	-	-	-
	AEX1315*S6HYB	4	3/4	6.0	2,400	6.4	15	-	-	-	-
	AEX1605*S6HYB	4	3/4	6.0	2,400	6.4	15	-	-	-	-
AEX1765*S6HYB	5	3/4	7.5	3,000	7.9	15	-	-	-	-	

Notes:

* = Voltage (see Nomenclature details)

^ = Motor Code Designator (see Nomenclature details)

SPECIFICATIONS

Hot Gas Defrost- 60 Hz

			3 Phase AC Washdown Rail Mount Motors					Drain Pan Heaters			
			208-230/3/60					No. of Heaters	Total Watts	230V/3/60 Hz	460V/3/60 Hz
Model	No. of Fans	HP	Amps	Watts	MCA	MOPD	Total Amps				
3 Fins Per Inch	AEX0325*S3HWP	1	3/4	3.2	600	4.0	15	-	-	-	-
	AEX0505*S3HWP	2	3/4	6.4	1,200	7.2	15	-	-	-	-
	AEX0595*S3HWP	2	3/4	6.4	1,200	7.2	15	-	-	-	-
	AEX0930*S3HWP	3	3/4	9.6	1,800	10.4	15	-	-	-	-
	AEX0975*S3HWP	4	3/4	12.8	2,400	13.6	15	-	-	-	-
	AEX1230*S3HWP	4	3/4	12.8	2,400	13.6	15	-	-	-	-
	AEX1620*S3HWP	5	3/4	16.0	3,000	16.8	20	-	-	-	-
4 Fins Per Inch	AEX0390*S4HWP	1	3/4	3.2	600	4.0	15	-	-	-	-
	AEX0580*S4HWP	2	3/4	6.4	1,200	7.2	15	-	-	-	-
	AEX0675*S4HWP	2	3/4	6.4	1,200	7.2	15	-	-	-	-
	AEX1050*S4HWP	3	3/4	9.6	1,800	10.4	15	-	-	-	-
	AEX1110*S4HWP	4	3/4	12.8	2,400	13.6	15	-	-	-	-
	AEX1385*S4HWP	4	3/4	12.8	2,400	13.6	15	-	-	-	-
	AEX1460*S4HWP	5	3/4	16.0	3,000	16.8	20	-	-	-	-
6 Fins Per Inch	AEX0475*S6HWP	1	3/4	3.2	600	4.0	15	-	-	-	-
	AEX0700*S6HWP	2	3/4	6.4	1,200	7.2	15	-	-	-	-
	AEX0805*S6HWP	2	3/4	6.4	1,200	7.2	15	-	-	-	-
	AEX1225*S6HWP	3	3/4	9.6	1,800	10.4	15	-	-	-	-
	AEX1315*S6HWP	4	3/4	12.8	2,400	13.6	15	-	-	-	-
	AEX1605*S6HWP	4	3/4	12.8	2,400	13.6	15	-	-	-	-
	AEX1765*S6HWP	5	3/4	16.0	3,000	16.8	20	-	-	-	-

Notes:

* = Voltage (see Nomenclature details)

^ = Motor Code Designator (see Nomenclature details)

SPECIFICATIONS

Hot Gas Defrost- 60 Hz

			3 Phase AC Washdown Rail Mount Motors					Drain Pan Heaters			
			460/3/60					No. of Heaters	Total Watts	230V/3/60 Hz	460V/3/60 Hz
Model	No. of Fans	HP	Amps	Watts	MCA	MOPD	Total Amps				
3 Fins Per Inch	AEX0325*S3HWP	1	3/4	1.6	600	2.0	15	-	-	-	-
	AEX0505*S3HWP	2	3/4	3.2	1,200	3.6	15	-	-	-	-
	AEX0595*S3HWP	2	3/4	3.2	1,200	3.6	15	-	-	-	-
	AEX0930*S3HWP	3	3/4	4.8	1,800	5.2	15	-	-	-	-
	AEX0975*S3HWP	4	3/4	6.4	2,400	6.8	15	-	-	-	-
	AEX1230*S3HWP	4	3/4	6.4	2,400	6.8	15	-	-	-	-
	AEX1620*S3HWP	5	3/4	8.0	3,000	8.4	15	-	-	-	-
4 Fins Per Inch	AEX0390*S4HWP	1	3/4	1.6	600	2.0	15	-	-	-	-
	AEX0580*S4HWP	2	3/4	3.2	1,200	3.6	15	-	-	-	-
	AEX0675*S4HWP	2	3/4	3.2	1,200	3.6	15	-	-	-	-
	AEX1050*S4HWP	3	3/4	4.8	1,800	5.2	15	-	-	-	-
	AEX1110*S4HWP	4	3/4	6.4	2,400	6.8	15	-	-	-	-
	AEX1385*S4HWP	4	3/4	6.4	2,400	6.8	15	-	-	-	-
	AEX1460*S4HWP	5	3/4	8.0	3,000	8.4	15	-	-	-	-
6 Fins Per Inch	AEX0475*S6HWP	1	3/4	1.6	600	2.0	15	-	-	-	-
	AEX0700*S6HWP	2	3/4	3.2	1,200	3.6	15	-	-	-	-
	AEX0805*S6HWP	2	3/4	3.2	1,200	3.6	15	-	-	-	-
	AEX1225*S6HWP	3	3/4	4.8	1,800	5.2	15	-	-	-	-
	AEX1315*S6HWP	4	3/4	6.4	2,400	6.8	15	-	-	-	-
	AEX1605*S6HWP	4	3/4	6.4	2,400	6.8	15	-	-	-	-
	AEX1765*S6HWP	5	3/4	8.0	3,000	8.4	15	-	-	-	-

Notes:

* = Voltage (see Nomenclature details)

SPECIFICATIONS

Hot Gas Defrost- 50 Hz

				380-400/3/50				Drain Pan Heaters		
				3 Phase AC Totally Enclosed Rail Mount Motors				No. of Heaters	Total Watts	380V/3/50 Hz
Model	No. of Fans	HP	Amps	Watts	MCA	MOPD	Total Amps			
3 Fins Per Inch	AEX0325 [^] S3H [^] B	1	3/4	1.7	600	2.1	15	-	-	-
	AEX0505 [^] S3H [^] B	2	3/4	3.4	1,200	3.8	15	-	-	-
	AEX0595 [^] S3H [^] B	2	3/4	3.4	1,200	3.8	15	-	-	-
	AEX0930 [^] S3H [^] B	3	3/4	5.1	1,800	5.5	15	-	-	-
	AEX0975 [^] S3H [^] B	4	3/4	6.8	2,400	7.2	15	-	-	-
	AEX1230 [^] S3H [^] B	4	3/4	6.8	2,400	7.2	15	-	-	-
	AEX1620 [^] S3H [^] B	5	3/4	8.5	3,000	8.9	15	-	-	-
4 Fins Per Inch	AEX0390 [^] S4H [^] B	1	3/4	1.7	600	2.1	15	-	-	-
	AEX0580 [^] S4H [^] B	2	3/4	3.4	1,200	3.8	15	-	-	-
	AEX0675 [^] S4H [^] B	2	3/4	3.4	1,200	3.8	15	-	-	-
	AEX1050 [^] S4H [^] B	3	3/4	5.1	1,800	5.5	15	-	-	-
	AEX1110 [^] S4H [^] B	4	3/4	6.8	2,400	7.2	15	-	-	-
	AEX1385 [^] S4H [^] B	4	3/4	6.8	2,400	7.2	15	-	-	-
	AEX1460 [^] S4H [^] B	5	3/4	8.5	3,000	8.9	15	-	-	-
6 Fins Per Inch	AEX0475 [^] S6H [^] B	1	3/4	1.7	600	2.1	15	-	-	-
	AEX0700 [^] S6H [^] B	2	3/4	3.4	1,200	3.8	15	-	-	-
	AEX0805 [^] S6H [^] B	2	3/4	3.4	1,200	3.8	15	-	-	-
	AEX1225 [^] S6H [^] B	3	3/4	5.1	1,800	5.5	15	-	-	-
	AEX1315 [^] S6H [^] B	4	3/4	6.8	2,400	7.2	15	-	-	-
	AEX1605 [^] S6H [^] B	4	3/4	6.8	2,400	7.2	15	-	-	-
	AEX1765 [^] S6H [^] B	5	3/4	8.5	3,000	8.9	15	-	-	-

Notes:

[^] = Motor Code Designator (see Nomenclature details)

SPECIFICATIONS

Hot Gas Defrost- 50 Hz

			380-400/3/50				Drain Pan Heaters			
			3 Phase AC Open Drip Proof Rail Mount Motors				No. of Heaters	Total Watts	380V/3/50 Hz	
Model	No. of Fans	HP	Amps	Watts	MCA	MOPD			Total Amps	
3 Fins Per Inch	AEX0325 [^] S3H [^] B	1	3/4	1.5	600	1.9	15	-	-	-
	AEX0505 [^] S3H [^] B	2	3/4	3.0	1,200	3.4	15	-	-	-
	AEX0595 [^] S3H [^] B	2	3/4	3.0	1,200	3.4	15	-	-	-
	AEX0930 [^] S3H [^] B	3	3/4	4.5	1,800	4.9	15	-	-	-
	AEX0975 [^] S3H [^] B	4	3/4	6.0	2,400	6.4	15	-	-	-
	AEX1230 [^] S3H [^] B	4	3/4	6.0	2,400	6.4	15	-	-	-
	AEX1620 [^] S3H [^] B	5	3/4	7.5	3,000	7.9	15	-	-	-
4 Fins Per Inch	AEX0390 [^] S4H [^] B	1	3/4	1.5	600	1.9	15	-	-	-
	AEX0580 [^] S4H [^] B	2	3/4	3.0	1,200	3.4	15	-	-	-
	AEX0675 [^] S4H [^] B	2	3/4	3.0	1,200	3.4	15	-	-	-
	AEX1050 [^] S4H [^] B	3	3/4	4.5	1,800	4.9	15	-	-	-
	AEX1110 [^] S4H [^] B	4	3/4	6.0	2,400	6.4	15	-	-	-
	AEX1385 [^] S4H [^] B	4	3/4	6.0	2,400	6.4	15	-	-	-
	AEX1460 [^] S4H [^] B	5	3/4	7.5	3,000	7.9	15	-	-	-
6 Fins Per Inch	AEX0475 [^] S6H [^] B	1	3/4	1.5	600	1.9	15	-	-	-
	AEX0700 [^] S6H [^] B	2	3/4	3.0	1,200	3.4	15	-	-	-
	AEX0805 [^] S6H [^] B	2	3/4	3.0	1,200	3.4	15	-	-	-
	AEX1225 [^] S6H [^] B	3	3/4	4.5	1,800	4.9	15	-	-	-
	AEX1315 [^] S6H [^] B	4	3/4	6.0	2,400	6.4	15	-	-	-
	AEX1605 [^] S6H [^] B	4	3/4	6.0	2,400	6.4	15	-	-	-
	AEX1765 [^] S6H [^] B	5	3/4	7.5	3,000	7.9	15	-	-	-

Notes:

[^] = Motor Code Designator (see Nomenclature details)

SPECIFICATIONS

Hot Gas Defrost- 50 Hz

			380-400/3/50				Drain Pan Heaters			
			3 Phase AC Washdown Rail Mount Motors				No. of Heaters	Total Watts	380V/3/50 Hz	
Model	No. of Fans	HP	Amps	Watts	MCA	MOPD			Total Amps	
3 Fins Per Inch	AEX0325 [^] S3H [^] B	1	3/4	1.6	600	2.0	15	-	-	-
	AEX0505 [^] S3H [^] B	2	3/4	3.2	1,200	3.6	15	-	-	-
	AEX0595 [^] S3H [^] B	2	3/4	3.2	1,200	3.6	15	-	-	-
	AEX0930 [^] S3H [^] B	3	3/4	4.8	1,800	5.2	15	-	-	-
	AEX0975 [^] S3H [^] B	4	3/4	6.4	2,400	6.8	15	-	-	-
	AEX1230 [^] S3H [^] B	4	3/4	6.4	2,400	6.8	15	-	-	-
	AEX1620 [^] S3H [^] B	5	3/4	8.0	3,000	8.4	15	-	-	-
4 Fins Per Inch	AEX0390 [^] S4H [^] B	1	3/4	1.6	600	2.0	15	-	-	-
	AEX0580 [^] S4H [^] B	2	3/4	3.2	1,200	3.6	15	-	-	-
	AEX0675 [^] S4H [^] B	2	3/4	3.2	1,200	3.6	15	-	-	-
	AEX1050 [^] S4H [^] B	3	3/4	4.8	1,800	5.2	15	-	-	-
	AEX1110 [^] S4H [^] B	4	3/4	6.4	2,400	6.8	15	-	-	-
	AEX1385 [^] S4H [^] B	4	3/4	6.4	2,400	6.8	15	-	-	-
	AEX1460 [^] S4H [^] B	5	3/4	8.0	3,000	8.4	15	-	-	-
6 Fins Per Inch	AEX0475 [^] S6H [^] B	1	3/4	1.6	600	2.0	15	-	-	-
	AEX0700 [^] S6H [^] B	2	3/4	3.2	1,200	3.6	15	-	-	-
	AEX0805 [^] S6H [^] B	2	3/4	3.2	1,200	3.6	15	-	-	-
	AEX1225 [^] S6H [^] B	3	3/4	4.8	1,800	5.2	15	-	-	-
	AEX1315 [^] S6H [^] B	4	3/4	6.4	2,400	6.8	15	-	-	-
	AEX1605 [^] S6H [^] B	4	3/4	6.4	2,400	6.8	15	-	-	-
	AEX1765 [^] S6H [^] B	5	3/4	8.0	3,000	8.4	15	-	-	-

Notes:

[^] = Motor Code Designator (see Nomenclature details)

SPECIFICATIONS

Electric Defrost- 50 Hz

				380-400/3/50				Drain Pan Heaters		
				3 Phase AC Open Drip Proof Rail Mount Motors				No. of Heaters	Total Watts	380V/3/50 Hz
Model	No. of Fans	HP	Amps	Watts	MCA	MOPD	Total Amps			
3 Fins Per Inch	AEX0325^S3H^B	1	1	1.5	960	1.9	15	-	-	-
	AEX0505^S3H^B	2	1	3.0	1,920	3.4	15	-	-	-
	AEX0595^S3H^B	2	1	3.0	1,920	3.4	15	-	-	-
	AEX0930^S3H^B	3	1	4.5	2,880	4.9	15	-	-	-
	AEX0975^S3H^B	4	1	6.0	3,840	6.4	15	-	-	-
	AEX1230^S3H^B	4	1	6.0	3,840	6.4	15	-	-	-
	AEX1620^S3H^B	5	1	7.5	4,800	7.9	15	-	-	-
4 Fins Per Inch	AEX0390^S4H^B	1	1	1.5	960	1.9	15	-	-	-
	AEX0580^S4H^B	2	1	3.0	1,920	3.4	15	-	-	-
	AEX0675^S4H^B	2	1	3.0	1,920	3.4	15	-	-	-
	AEX1050^S4H^B	3	1	4.5	2,880	4.9	15	-	-	-
	AEX1110^S4H^B	4	1	6.0	3,840	6.4	15	-	-	-
	AEX1385^S4H^B	4	1	6.0	3,840	6.4	15	-	-	-
	AEX1460^S4H^B	5	1	7.5	4,800	7.9	15	-	-	-
6 Fins Per Inch	AEX0475^S6H^B	1	1	1.5	960	1.9	15	-	-	-
	AEX0700^S6H^B	2	1	3.0	1,920	3.4	15	-	-	-
	AEX0805^S6H^B	2	1	3.0	1,920	3.4	15	-	-	-
	AEX1225^S6H^B	3	1	4.5	2,880	4.9	15	-	-	-
	AEX1315^S6H^B	4	1	6.0	3,840	6.4	15	-	-	-
	AEX1605^S6H^B	4	1	6.0	3,840	6.4	15	-	-	-
	AEX1765^S6H^B	5	1	7.5	4,800	7.9	15	-	-	-

Notes:

^ = Motor Code Designator (see Nomenclature details)

PHYSICAL DATA

Air Defrost

							Est. Net Weight	
							lbs.	kg
	Model	No. of Fans	Coil Inlet OD	Suction OD	Equalizer OD	Drain MPT		
4 Fins Per Inch	AEX0390*S4A^B	1	7/8	15/8	1/4	1 1/2	500	227
	AEX0580*S4A^B	2	1 1/8	15/8	1/4	1 1/2	700	317
	AEX0675*S4A^B	2	1 1/8	15/8	1/4	1 1/2	700	317
	AEX1050*S4A^B	3	1 1/8	15/8	1/4	1 1/2	950	431
	AEX1110*S4A^B	4	1 1/8	15/8	1/4	1 1/2	1,200	544
	AEX1385*S4A^B	4	1 3/8	15/8	1/4	1 1/2	1,200	544
	AEX1460*S4A^B	5	1 3/8	15/8	1/4	1 1/2	1,450	658
6 Fins Per Inch	AEX0475*S6A^B	1	7/8	15/8	1/4	1 1/2	500	227
	AEX0700*S6A^B	2	1 1/8	15/8	1/4	1 1/2	700	317
	AEX0805*S6A^B	2	1 1/8	15/8	1/4	1 1/2	700	317
	AEX1225*S6A^B	3	1 1/8	15/8	1/4	1 1/2	950	431
	AEX1315*S6A^B	4	1 3/8	15/8	1/4	1 1/2	1,200	544
	AEX1605*S6A^B	4	1 3/8	15/8	1/4	1 1/2	1,200	544
	AEX1765*S6A^B	5	1 3/8	15/8	1/4	1 1/2	1,450	658

Notes:

* = Electrical Code Designator (see Nomenclature details)

^ = Motor Code Designator (see Nomenclature details)

PHYSICAL DATA

Electric Defrost

	Model	No. of Fans	Coil Inlet OD	Suction OD	Equalizer OD	Drain MPT	Est. Net Weight	
							lbs.	kg
3 Fins Per Inch	AEX0325*S3E^B	1	7/8	15/8	1/4	1 1/2	500	227
	AEX0505*S3E^B	2	7/8	15/8	1/4	1 1/2	700	317
	AEX0595*S3E^B	2	1 1/8	15/8	1/4	1 1/2	700	317
	AEX0930*S3E^B	3	1 1/8	15/8	1/4	1 1/2	950	431
	AEX0975*S3E^B	4	1 1/8	15/8	1/4	1 1/2	1,200	544
	AEX1230*S3E^B	4	1 3/8	15/8	1/4	1 1/2	1,200	544
	AEX1620*S3E^B	5	1 3/8	15/8	1/4	1 1/2	1,450	658
4 Fins Per Inch	AEX0390*S4E^B	1	7/8	15/8	1/4	1 1/2	500	227
	AEX0580*S4E^B	2	1 1/8	15/8	1/4	1 1/2	700	317
	AEX0675*S4E^B	2	1 1/8	15/8	1/4	1 1/2	700	317
	AEX1050*S4E^B	3	1 1/8	15/8	1/4	1 1/2	950	431
	AEX1110*S4E^B	4	1 1/8	15/8	1/4	1 1/2	1,200	544
	AEX1385*S4E^B	4	1 3/8	15/8	1/4	1 1/2	1,200	544
	AEX1460*S4E^B	5	1 3/8	15/8	1/4	1 1/2	1,450	658
6 Fins Per Inch	AEX0475*S6E^B	1	7/8	15/8	1/4	1 1/2	500	227
	AEX0700*S6E^B	2	1 1/8	15/8	1/4	1 1/2	700	317
	AEX0805*S6E^B	2	1 1/8	15/8	1/4	1 1/2	700	317
	AEX1225*S6E^B	3	1 1/8	15/8	1/4	1 1/2	950	431
	AEX1315*S6E^B	4	1 3/8	15/8	1/4	1 1/2	1,200	544
	AEX1605*S6E^B	4	1 3/8	15/8	1/4	1 1/2	1,200	544
	AEX1765*S6E^B	5	1 3/8	15/8	1/4	1 1/2	1,450	658

Notes:

* = Electrical Code Designator (see Nomenclature details)

^ = Motor Code Designator (see Nomenclature details)

PHYSICAL DATA

Hot Gas Defrost

									Est. Net Weight	
	Model	No. of Fans	Coil Inlet OD	Suction OD	Equalizer OD	Drain MPT	Side Port OD	Hot Gas Pan Conns OD	lbs.	kg
3 Fins Per Inch	AEX0325*S3H^B	1	7/8	15/8	1/4	1 1/2	Conns	15/8	531	241
	AEX0505*S3H^B	2	7/8	15/8	1/4	1 1/2	1/2	15/8	742	336
	AEX0595*S3H^B	2	1 1/8	15/8	1/4	1 1/2	5/8	15/8	742	336
	AEX0930*S3H^B	3	1 1/8	15/8	1/4	1 1/2	5/8	15/8	1,001	454
	AEX0975*S3H^B	4	1 1/8	15/8	1/4	1 1/2	5/8	15/8	1,260	572
	AEX1230*S3H^B	4	1 3/8	15/8	1/4	1 1/2	7/8	15/8	1,260	572
	AEX1620*S3H^B	5	1 3/8	15/8	1/4	1 1/2	7/8	15/8	1,518	689
4 Fins Per Inch	AEX0390*S4H^B	1	7/8	15/8	1/4	1 1/2	1/2	15/8	531	241
	AEX0580*S4H^B	2	1 1/8	15/8	1/4	1 1/2	5/8	15/8	742	336
	AEX0675*S4H^B	2	1 1/8	15/8	1/4	1 1/2	5/8	15/8	742	336
	AEX1050*S4H^B	3	1 1/8	15/8	1/4	1 1/2	5/8	15/8	1,001	454
	AEX1110*S4H^B	4	1 1/8	15/8	1/4	1 1/2	5/8	15/8	1,260	572
	AEX1385*S4H^B	4	1 3/8	15/8	1/4	1 1/2	7/8	15/8	1,260	572
	AEX1460*S4H^B	5	1 3/8	15/8	1/4	1 1/2	7/8	15/8	1,518	689
6 Fins Per Inch	AEX0475*S6H^B	1	7/8	15/8	1/4	1 1/2	1/2	15/8	531	241
	AEX0700*S6H^B	2	1 1/8	15/8	1/4	1 1/2	5/8	15/8	742	336
	AEX0805*S6H^B	2	1 1/8	15/8	1/4	1 1/2	5/8	15/8	742	336
	AEX1225*S6H^B	3	1 1/8	15/8	1/4	1 1/2	5/8	15/8	1,001	454
	AEX1315*S6H^B	4	1 3/8	15/8	1/4	1 1/2	7/8	15/8	1,260	572
	AEX1605*S6H^B	4	1 3/8	15/8	1/4	1 1/2	7/8	15/8	1,260	572
	AEX1765*S6H^B	5	1 3/8	15/8	1/4	1 1/2	7/8	15/8	1,518	689

Notes:

* = Electrical Code Designator (see Nomenclature details)

^ = Motor Code Designator (see Nomenclature details)

DIMENSIONAL DATA

Air and Electric Defrost Models

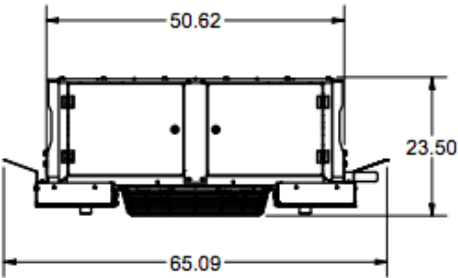
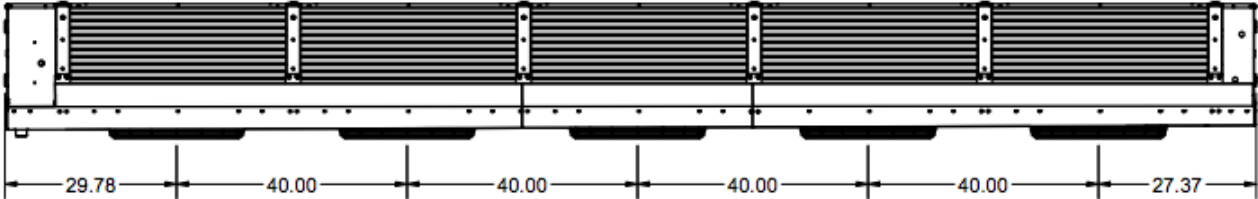
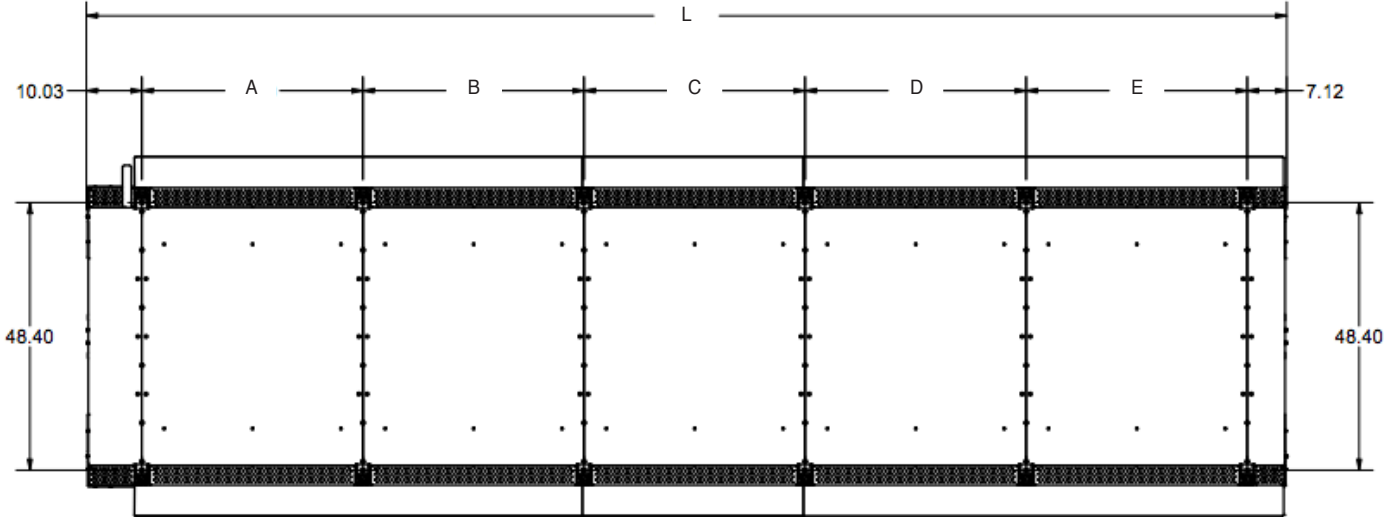

No. of Fans	L		A		B		C		D		E	
	in.	mm	in.	mm	in.	mm	in.	mm	in.	mm	in.	mm
1	57.24	1,454	40	1,016	-	-	-	-	-	-	-	-
2	97.23	2,470	40	1,016	40	1,016	-	-	-	-	-	-
3	137.23	3,486	40	1,016	40	1,016	40	1,016	-	-	-	-
4	177.16	4,500	40	1,016	40	1,016	40	1,016	40	1,016	-	-
5	217.16	5,516	40	1,016	40	1,016	40	1,016	40	1,016	40	1,016

DIMENSIONAL DATA

Hot Gas Defrost Models

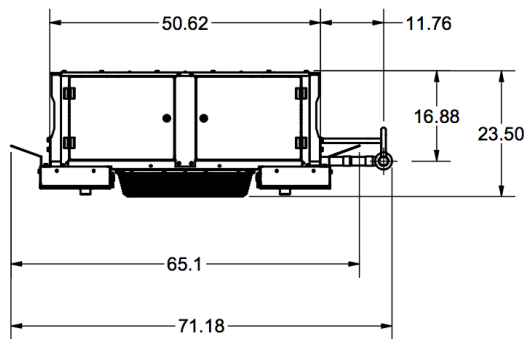
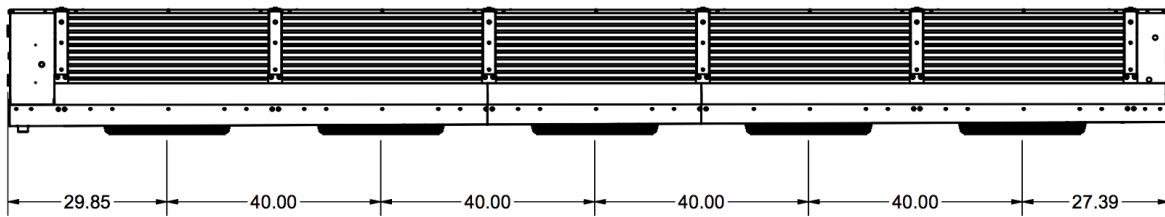
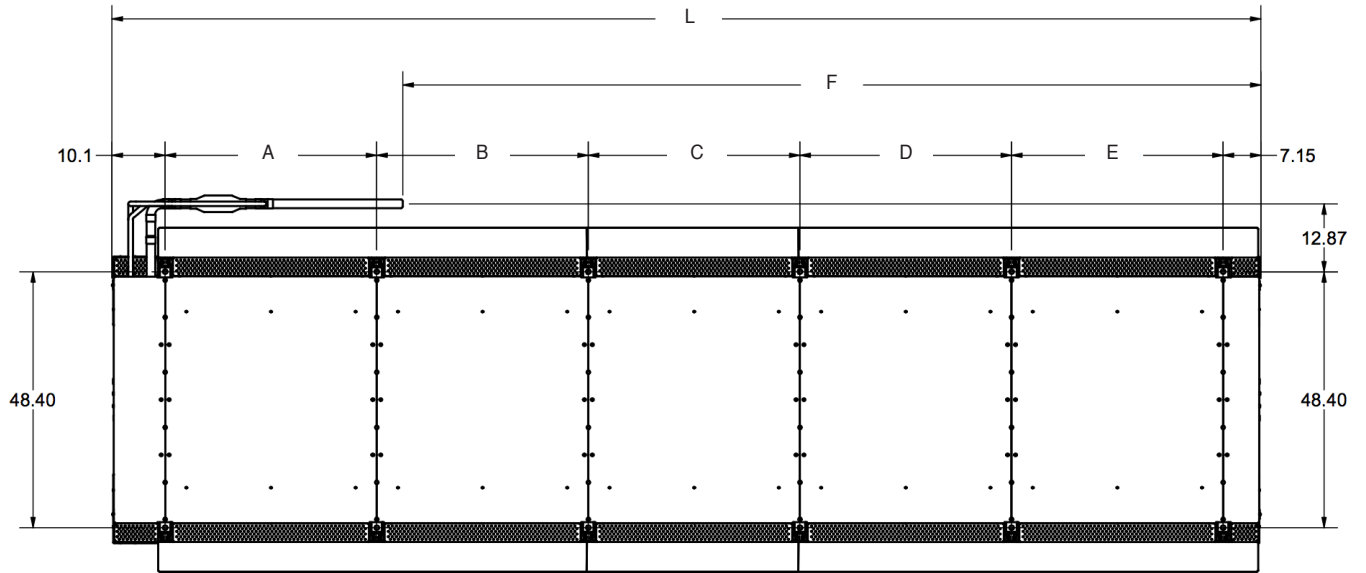

No. of Fans	L		A		B		C		D		E		F	
	in.	mm	in.	mm	in.	mm	in.	mm	in.	mm	in.	mm	in.	mm
1	57.24	1,454	40	1,016	-	-	-	-	-	-	-	-	2.14	54
2	97.25	2,470	40	1,016	40	1,016	-	-	-	-	-	-	42.17	1,071
3	137.25	3,486	40	1,016	40	1,016	40	1,016	-	-	-	-	82.12	2,086
4	177.25	4,500	40	1,016	40	1,016	40	1,016	40	1,016	-	-	122.17	3,103
5	217.25	5,516	40	1,016	40	1,016	40	1,016	40	1,016	40	1,016	162.17	4,119



2175 West Park Place Blvd.

Stone Mountain, GA 30087

Phone: 800.537.7775 · Fax: 770.465.5900

magnarefrigeration.com



Since product improvement is a continuing effort, we reserve the right to make changes in specifications without notice.

XCM-0324 | Version 003

©2024 Heatcraft Refrigeration Products LLC